

ajacovides
Andreas Jacovides Trading Ltd



2025

Γάντια και Στολές Προστασίας



BUSINESS PROFILE

Andreas Jacovides Trading Ltd is praised as a pioneering force in delivering leading performance solutions and products enhanced by high-quality standards and environmental awareness.

Our company was founded in 1982 and became a Leader in the supply and distribution of innovative products in the Cyprus Market.

We invest heavily in building excellent customer service and support through our highly skilled engineers and staff. Emphasis is given in creating outstanding relationship with our clients and suppliers and we constantly focus on our partner's business needs. Based on our experience and in-depth technical knowledge we have achieved recognition as a trustworthy and reliable partner on whom our clients and associates can rely.

The company has its head offices in Latsia Industrial Area at the outskirts of Nicosia. This allows easy access all over Cyprus with fast and express delivery.

WHAT WE DO

We are importers of a wide range of industrial products.
The major groups of products we offer are:

- ▶ Aluminium Composite Panels
- ▶ Polycarbonate & Polyester Sheets
- ▶ Pvc & Acrylic Sheets
- ▶ Decorative Films
- ▶ Solar Films
- ▶ Safety & Security Films
- ▶ Graphic and Digital Printing
- ▶ Powder Coating
- ▶ LED & Power Supplies

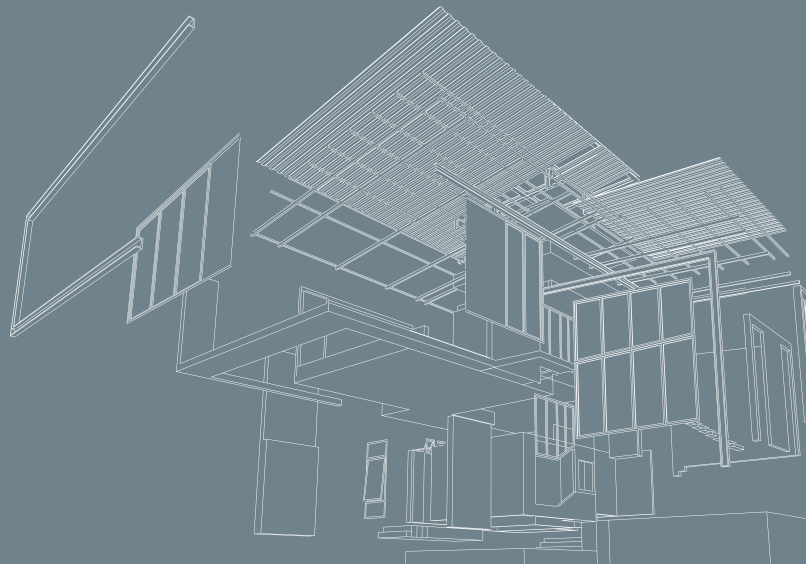

Commercial Graphics & HP Large format printers

Printable, Decorative, Reflective, Solar, Safety Films
Large Format Printers • Signage CNC Routers
Acrylic, Pvc, Foam Sheets • Signage systems



Architectural & Interior Design

Building Materials • Aluminium Composite panels
Pvc Composite Sheets • Acrylic Sheets
Multi & Solid Polycarbonate Sheets



Powder Coatings

Powder Coating for all metallic creations: • Windows & doors
Facades, curtain walling & metal shells • Sunshades & shutters
Fencing, railings & handrails • Ceiling tiles • Garage doors
Verandas, winter gardens, greenhouses & conservatories



Sun Control Films Safety & Security Films



3M
Authorized Distributor
Industrial Products

Personal Safety Equipment

Προστασία αναπνοής, ακοής, όρασης, κεφαλής
Μάσκες προσώπου για όλους τους επαγγελματίες
Ζώνες προστασίας • Φωσφορούχα γιλέκα, στολές
Μάσκες συγκολλητών



3M
Authorized Distributor
Industrial Products

Display Stands

Roll-up • X-banner • Pop up Magnetic Spider
Promotion Table • Wall snap frame
A board snap frame • Brochure holder • Teardrop & Feather Flag



Aluminium Sign Systems

Textile Aluminium frames Indoor • Wall Banner frames
Acrylic outdoor frames • Info System • Bannerbox outdoor
Clip frames • Pylon outdoor signs
Readymade Panel & Magnetic Led Frames



Led Lighting & Power Supply

Led strips • Led modules • Power supply • Transformers
KNX • Illuminated Led sign Systems • Neon Flex



Traffic Safety & Signage

Traffic Signs • Street name signs • Cones • Bollards • Barriers
Speed Reducer • Road Studs • Solar Warning Lamps • Mirrors
Solar Cat Eyes • Directional Led Panel • Led Traffic Light
Warning Trailer • Pedestrian Safe System • Road Marking Paints



Glass Machinery & Applications

Glazing Machinery
Tables for floating and laminated glass cutting
Φούφοι Laminated / tempered
Aluminium spacers for glass



Chemicals & Activated carbon

Wide range of industry-leading activated carbon solutions,
serving the transportation, infrastructure,
pharmaceutical and environmental industry in Cyprus.



Medical Procurement

Laryngectomy care products
Atos Medical® product series refer to a broad product range of voice
and pulmonary rehabilitation devices consisted in voice prosthesis,
HME and speaking valves, adhesives and supplemental
accessories for Stoma covers.





ANSELL SAFETY SOLUTIONS

FIND THE RIGHT GLOVE SIZE

1. METHOD 1 - CIRCUMFERENCE

Correct sizing is essential for ensuring glove comfort. The ideal way to determine size is with a dressmaker's cloth tape. Use it to measure the circumference of the palm of the hand at its widest point, in millimetre. Cross-reference that measurement against the table provided here. Most gloves with knitwrist are colour coded for size identification as below.

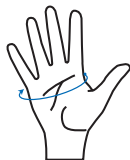

	Size	Hand circumference	Cuff colour
XXS	5	137 mm	Pink
XS	6	152 mm	Purple
S	7	178 mm	Red
M	8	203 mm	Yellow
L	9	229 mm	Brown
XL	10	254 mm	Black
XXL	11	279 mm	Light blue
XXXL	12	295 mm	Green

Note: This chart is intended to be used as a guide only.

2. METHOD 2 - CHECK YOUR GLOVE SIZE

Place your right hand palm down on the drawing with your fingers together. Your index finger should be aligned with the blue line (but not over it), your thumb crotch placed correspondingly to the portrayed hand. Size is indicated by the width of your hand. Read your size on the coloured lines.

Instructions for use :
To be printed on A4 (100%)

Ansell, ® and ™ are trademarks owned by Ansell Limited or one of its affiliates.
© 2019 Ansell Limited. All Rights Reserved

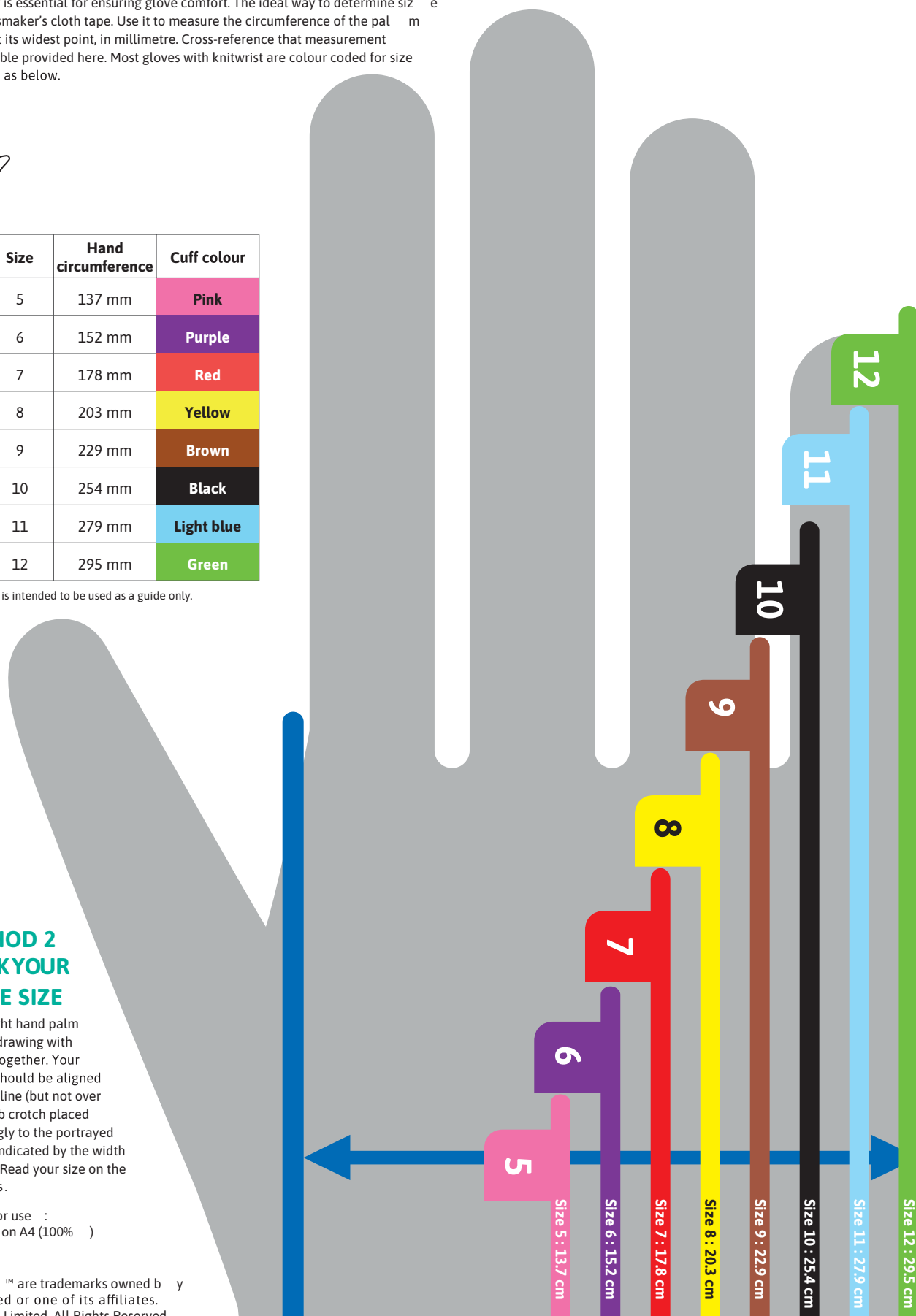



Built on over 125 years of experience in product innovations that improve worker experience, Ansell has a range of proprietary technologies that differentiate our products from the competition. Worker Experience Innovation by Ansell focuses on three benefit-based innovation platforms – comfort, performance and protection.

COMFORT TECHNOLOGIES

AQUADRI™ Moisture Management Technology

AQUADRI™ Technology produces a drier, cooler and more comfortable fit that dries the hand by dissipating heat, or through an open-celled foam layer that wicks moisture into its micropores, or both.

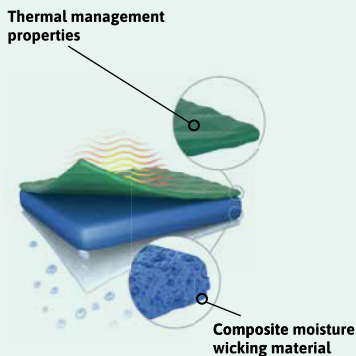

ZONZ™ Comfort Fit Technology

ZONZ™ Technology uses selected yarns and varying knit construction to optimize overall glove fit and enhance hand movement for higher dexterity and reduced fatigue.

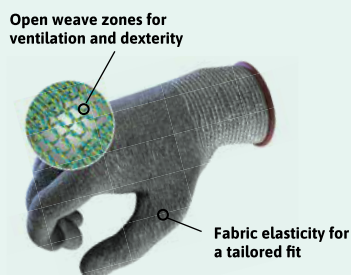

PERFORMANCE TECHNOLOGIES

ANSELL GRIP™ Ansell Grip Technology

ANSELL GRIP™ Technology is a coating treatment that minimizes the force required to grip dry, oily and wet tools or materials, reducing hand and arm fatigue and improving dexterity, safety and productivity.

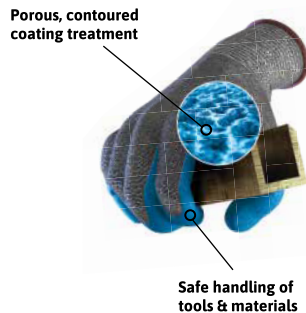

ERGOFORM™ Ergonomic Design Technology

ERGOFORM™ Technology enables Ansell to design safety solutions that support musculoskeletal health during repetitive tasks to improve worker performance.

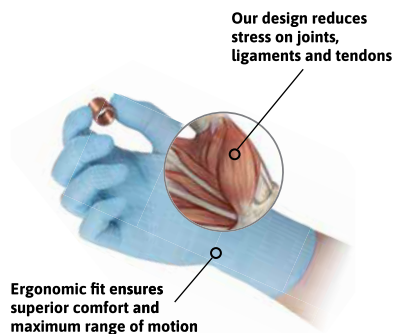

FORTIX™ Abrasion Resistance Technology

FORTIX™ Technology enhances the coating performance by integrating a resilient polymer formulation throughout the glove coating and/or in targeted high wear areas to extend the working life of the glove while improving worker comfort.

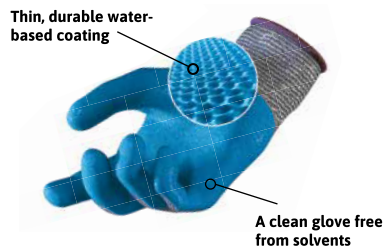

PROTECTION TECHNOLOGIES

INTERCEPT™ Cut Resistance Technology

INTERCEPT™ Technology blends engineered, synthetic and natural fibers into high-performance yarns that provide high cut protection in targeted areas of cut risk, along with great comfort and high dexterity.

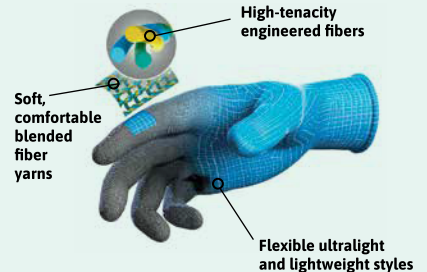

MICROCHEM™ Chemical Barrier Technology

MICROCHEM™ Chemical Barrier Technology combines polymers in proprietary blends or multi-layer structures specific to their application, providing superior protection to wearers in Chemical, Biological, Radiological and Nuclear (CBRN) environments.*

Multi-layer barrier to particulate, liquid and gaseous chemicals

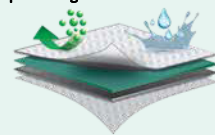

RIPEL™ Liquid Repellence Technology

RIPEL™ Liquid Repellence Technology is a repellent surface barrier that prevents oils, lubricants, chemicals or other liquids from making even incidental contact with the wearer's skin.

Repellent coating creates a barrier to oil, lubricant, chemical or liquid contact

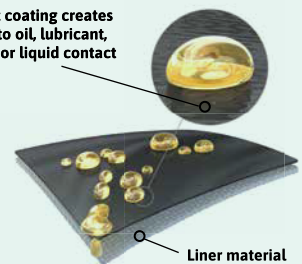

TNT™ Chemical Splash Resistance Technology

TNT™ Technology provides superior splash resistance against a wide range of hazardous chemicals, for durable protection with a soft, comfortable feel.

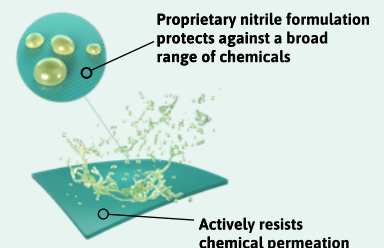

What is OEKO-TEX®?

OEKO-TEX® offers a consistent, independent testing and certification system for raw, semi-finished and finished textile products. The focus is on ensuring textile manufacturing processes are conducted in compliance with key regulatory requirements. Especially with regard to banned substances like Azo colorants, formaldehyde, pentachlorophenol, cadmium, nickel and more. OEKO-TEX® also adheres to the requirements from the US Consumer Product Safety Improvement Act (CPSIA) regarding lead usage. The test criteria employed by OEKO-TEX® goes beyond the necessary national and international regulations in assessing the quality of materials used to protect wearers.



What does “Dermatologically Tested” mean?

The skin friendliness of our gloves is evaluated by an external German laboratory to ensure a fair and accurate assessment. The irritant potential of our products is examined in a 3 x 24-hour patch test on 32 subjects. Areas such as the cuff, palm and back of the hands will be tested. After 24 hours of wear, a trained grader will assess the skin irritation caused by the different products. If the grader concludes that the test has induced no skin irritation at all, then Ansell would be allowed to claim that the skin tolerability of these products is rated good. This will establish that the product has been ‘Dermatologically Tested’.



Brand	Category
	Specialty Impact Hand Protection
ACTIVARMR®	Mechanical Protection/ Hand & Body Protection
AlphaTec®	Chemical Protection/ Hand & Body Protection
	Critical Environment s/ Disposable Hand & Body Protection
HyFlex®	Mechanical Protection/ Hand & Body Protection
MICRO⊕FLEX®	Single Use
TouchNTuff®	Single Use

MECHANICAL - INDUSTRIAL PROTECTION

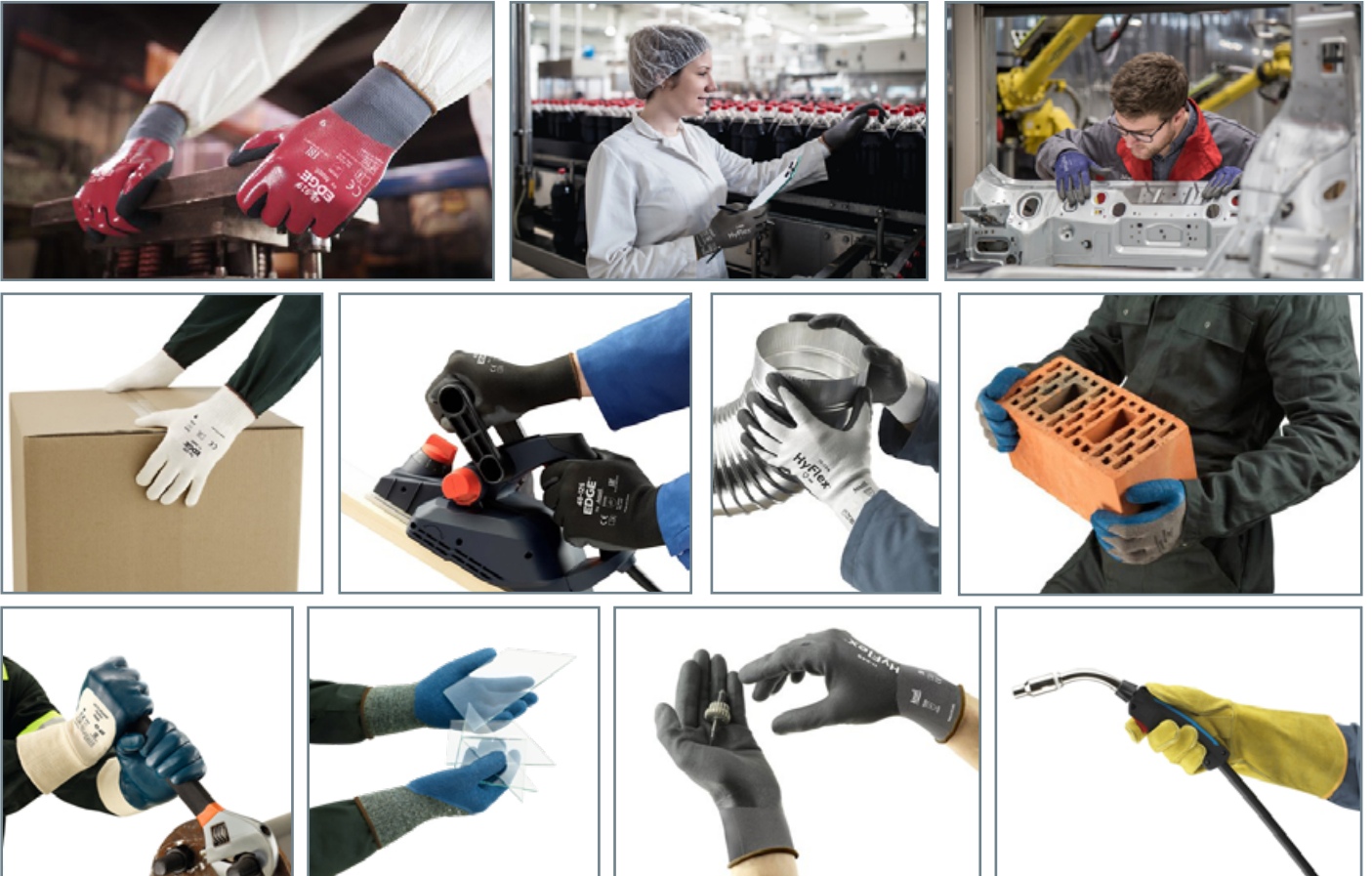

Industries

- Automotive
- Construction
- Machinery and Equipment
- Metal fabrication
- Chemical
- Oil and gas
- Assembly of small parts
- General handling
- Raw material handling
- Picking, fastening components
- Adjusting systems and screwing

CODE	DESCRIPTION
ANSELL-11-840 SIZE: 8, 9, 10	11-840-Ansell FORTIX™ nitrile foam coating on 15 gauge nylon-spandex liner, Palm coated. Knitwrist. Length 200-275 mm (8- 10 inch). Grey/Black



11-840

Our best seller in general handling

Durable industrial gloves, offering 2x more grip and up to 20% greater abrasion protection*



Multi Purpose
Abrasion Protection
Ergonomic Protection



Light Duty

Applications

- Assembly of small parts
- General handling
- Raw material handling
- Picking, fastening components
- Adjusting systems and screwing

Industries

- Aerospace
- Automotive
- Machinery and Equipment
- Metal fabrication
- Automotive Aftermarket
- Emergency Medical Services
- Food Processing
- Oil and gas
- Utilities
- Warehousing



Key Features

- **FORTIX™ Abrasion Resistance:** 2x more grip, up to 20% more durability*
- **ERGOFORM™ Ergonomic Design:** Reduced strain, better ergonomics
- **ZONZ™ Comfort Fit:** For safety gloves that offer breathable comfort *vs. previous technology version

Technologies

- ANSELL GRIP™**
Ansell Grip Technology
- ERGOFORM™**
Ergonomic Design Technology
- FORTIX™**
Abrasion Resistance Technology
- ZONZ™**
Comfort Fit Technology

Performance Standards & Regulatory Compliance

REACH Compliant



Specifications

BRAND STYLE	DESCRIPTION	Gauge	SIZE	LENGTH	COLOR	PACKAGE
HyFlex® 11-840F	Finishing: Palm Coated Coating Material: Foam Nitrile Liner Material: Nylon, Spandex Cuff Style: Knitwrist	15	8, 9, 10	200-275 mm/ 8-11 inches	Black	• 12 pairs in a bag; 12 bags in a carton

CODE	DESCRIPTION
ANSELL-11-849 SIZE: 9,10	11-849-Ansell FORTIX nitrile foam coating on 18 gauge nylon-spandex liner. Fully dipped. 210-255 mm. Black

HyFlex®

ADVANCED MECHANICAL PROTECTION

11-849

Extra protection for longer period of wear

Durable, comfortable industrial gloves with fully dipped nitrile coating, for 360° coverage



Multi Purpose

Ergonomic Protection



Light Duty

Industries

- Automotive
- Machinery and Equipment
- Metal fabrication
- Transportation
- Automotive Aftermarket

Applications

- Picking, fastening components
- Fastening components, parts
- Transport & Logistics
- General handling
- Occasional handling of hot objects : EN407 Contact Heat class 1 (100°C for 15s)



Key Features

- **Fully dipped coating:** Industrial gloves with 360° hand protection
- **FORTIX™ Abrasion Resistance:** 2x more grip, up to 20% more durability
- **Silicone-free:** No contaminant transfer to metal prior to painting

Vulcanization Chemical Accelerators

- Zinc Diethyldithiocarbamate

Only a very small number of users may be sensitive to this ingredient(s) and hence may develop irritant and/or allergic contact reactions .

Technologies



Performance Standards & Regulatory Compliance

REACH Compliant



Specifications

BRAND STYLE	DESCRIPTION	Gauge	SIZE	LENGTH	COLOR	PACKAGE
HyFlex® 11-849	Finishing: Fully Coated Coating Material: Foam Nitrile Liner Material: Spandex, Nylon Cuff Style: Knitwrist	18	9, 10	210-255 mm, 8.3-10 inches	Black	12 pairs/bag, 12 bags/carton

CODE	DESCRIPTION
ANSELL-48-126-PU PU SIZE: 8, 9,10,11	48-126-PU palm coated on polyester seamless liner. Knitwrist. Length 220-270 mm (8-10 inch). Black

EDGE[®]
INDUSTRIAL WORK GLOVES

48-126

Light Duty Multi-purpose Industrial Glove



Multi Purpose Abrasion Protection



Light Duty

Cost effective solution for light duty applications requiring a good level of abrasion resistance & grip, as well as high tactility in dry to slightly oily environments.

Industries

- Automotive
- Electronics
- Machinery and Equipment
- Oil and gas
- Transportation
- Utilities

Applications

- Assembly of small pieces
- General handling
- Packaging
- Quality inspection



Key Features

- Black glove shows dirt less, gloves are discarded less quickly
- Seamless structure; ensures comfort and encourages safety and glove usage

Vulcanization Chemical Accelerators

- Natural rubber proteins

Only a very small number of users may be sensitive to this ingredient(s) and hence may develop irritant and/or allergic contact reactions .

Performance Standards & Regulatory Compliance

REACH Compliant



4121A

Specifications

BRAND STYLE	DESCRIPTION	Gauge	SIZE	LENGTH	COLOR	PACKAGE
EDGE [®] 48-126	Finishing: Palm dipped Coating Material: Polyurethane Liner Material: Polyester Cuff Style: Knitwrist	15	8, 9, 10, 11	215-270 mm, 8.46-10.63 inches	Black	• 12 pairs/bag, 12 bags/carton

CODE	DESCRIPTION
ANSELL-11-801 SIZE: 9,10	Industrial safety gloves with 30% greater breathability and a dirt-masking dark liner



11-801

Improved design delivers enhanced comfort in a dirt masking color

Industrial safety gloves with 30% greater breathability and a dirt-masking dark liner



Multi Purpose



Light Duty

Industries

- Automotive
- Machinery and Equipment
- Metal fabrication
- Chemical

Applications

- Picking, fastening components
- Adjusting systems and screwing
- Loading and unloading trucks and vehicles
- Handling incoming goods
- Product shipping, transport and delivery
- Lock smith



Key Features

- Darker liner:** For safety gloves suited to dirty or oily conditions
- Breathable nitrile coating:** PPE gloves that offer all-day comfort
- ZONZ™ Comfort Fit Technology:** Reduced tension, greater usability

Technologies



DMF free



Performance Standards & Regulatory Compliance



ANSI/ISEA 105-2024







EN388: 2016



3131A



STANDARD 100

1408033 Centexbel

Specifications

BRAND STYLE	DESCRIPTION	Gauge	SIZE	LENGTH	COATING COLOR	PACKAGE
HyFlex® 11-801	Finishing: Palm Coated Coating Material: Foam Nitrile Liner Material: Nylon Cuff Style: Knitwrist	15	9, 10	214-280 mm/ 8.42-11.02 inches	Black	12 pairs/bag, 12 bags/carton

CODE	DESCRIPTION
ANSSELL-48-305 SIZE: 9,10	Industrial gloves offering abrasion resistance as well as a secure wet and dry grip

EDGE[®]
INDUSTRIAL WORK GLOVES

48-305

Medium duty general purpose industrial glove

An economical solution to replace leather or thick cotton gloves and provide better cost/benefit

- EDGE[®] 48-305 industrial work gloves are the economical solution for medium weight applications requiring a good level of abrasion resistance along with a good grip in dry or wet environments.
- EDGE[®] 48-305 is the economical choice for use in a wide range of handling and carrying applications, and are more durable than medium weight cotton or leather gloves.
- Size 7 to 10, identified by overedge colour code.



Industries

- Automotive
- Warehousing
- Transportation

Applications

- General handling
- Packaging
- Shipping
- Street cleaning and refuse collection

Key Features

- Dexterity and flexibility: Ideal for handling and carrying tasks
- Abrasion and tear resistance: Durable, long-lasting safety gloves
- Sure grip in dry and wet environments: Optimal hand protection

Vulcanization Chemical Accelerators

- Natural rubber proteins
- Natural rubber proteins (in knitwrist elastic)
- Zinc Diethyldithiocarbamate

Only a very small number of users may be sensitive to this ingredient(s) and hence may develop irritant and/or allergic contact reactions.

Performance Standards & Regulatory Compliance



2142B

Specifications

BRAND STYLE	DESCRIPTION	Gauge	SIZE	LENGTH	COATING COLOR	PACKAGE
EDGE 48-305	Finishing: Palm Coated Coating Material: Natural Rubber Latex Liner Material: Polyester Cuff Style: Knitwrist	10	9, 10	230 / 9.1	Blue	• 12 pairs/bag; 12 bags/carton

CODE	DESCRIPTION
ANSELL-48-919 SIZE: 9,10,11	48-919-Double dipped nitrile coating on polyester liner. Fully dipped. Grey liner with black/dark red coating. Length: 220-270 mm

EDGE[®]
INDUSTRIAL WORK GLOVES

48-919

Light duty multi-purpose industrial glove

Cost effective solution for light weight applications requiring a durable coating and secure grip in oily environments

Industries

- Automotive
- Construction
- Machinery and Equipment
- Metal fabrication
- Chemical
- Oil and gas

Applications

- Assembly of parts
- Maintenance
- Metal Fabrication
- Quality control



Cut



Light Duty



Multi Purpose



Oil



Key Features

- Good combination of grip & oil repellence
- Excellent abrasion resistance
- Double layer nitrile coating keeps hands dry and comfortable when handling oily parts and tools
- In compliance with the standards EN420 (General requirements) and EN388 (Mechanical hazards)
- Elastic knit-wrist ensures snug fit
- Applicable in oily environments

Performance Standards & Regulatory Compliance

REACH Compliant



Specifications

BRAND STYLE	DESCRIPTION	Gauge	SIZE	LENGTH	COLOR	PACKAGE
EDGE [®] 48-919F	Finishing: Rough Coating Material: Nitrile Liner Material: Polyester Cuff Style: Knitwrist	13	9, 10, 11	220-280 mm, 8.66-11.02 inches	Black and Red	12 pairs/bag, 12 bags/carton

CODE	DESCRIPTION
ANSELL-11-561 SIZE: 7, 8, 9, 10, 11	11-561-Nitrile coated nylon, Lycra, HPPE liner. Palm dipped with thumb crotch reinforcement. Grey/Blue. 210-285 mm

HyFlex®

ADVANCED MECHANICAL PROTECTION

11-561

All-day comfort & cut protection

The thinnest, lightest EN ISO C/ANSI A3-level industrial gloves, offering 100% greater durability*



Cut



Light Duty

Industries

- Automotive
- Machinery and Equipment
- Metal fabrication
- Mining
- Oil and gas
- Automotive Aftermarket

Applications

- Handling metal sheets & panels
- Handling parts with sharp, rough edges
- Final assembly
- Handling materials with sharp or rough edges
- Assembly & inspection of components
- Applying finish to materials, products



Key Features

- **FORTIX™ Technology:** Up to 20% greater abrasion resistance^
- **INTERCEPT™ Cut Resistance:** Better hand protection and workplace safety
- **Palm-dipped coating:** For breathable PPE gloves with superior grip
*when compared with nearest market competitors
^versus previous technology version

Technologies



DMF free



Fibre glass free



FORTIX™
Abrasion Resistance Technology



INTERCEPT™
Cut Resistance Technology

Performance Standards & Regulatory Compliance

REACH Compliant



Specifications

BRAND STYLE	DESCRIPTION	Gauge	SIZE	LENGTH	COLOR	PACKAGE
HyFlex® 11-561F	Finishing: Palm Coated Coating Material: Nitrile Liner Material: Nylon, HPPE, Basalt, Spandex, Polyester Cuff Style: Knitwrist	15	7, 8, 9, 10, 11	210-285 mm	Grey	12 pairs/bag, 12 bags/carton

CODE	DESCRIPTION
ANSELL-11-724-PU SIZE: 9,10	11-724-PU coating on a seamless liner. 13 gauge. INTERCEPT Technology®. Palm dipped. Knitwrist. Length 208-261mm. White liner with black coating.

HyFlex®

ADVANCED MECHANICAL PROTECTION

11-724

Light and comfortable protection against cuts and abrasion

Lightweight abrasion-resistant gloves that protect with exceptional durability



Cut



Medium Duty

Industries

- Automotive
- Machinery and Equipment
- Metal fabrication
- Chemical

Applications

- Assembly & inspection of components
- Assembly and disassembly of equipment
- Mounting and dismantling
- Applying finish to materials, products
- Loading and unloading trucks and vehicles
- Handling incoming goods
- Maintenance
- Opening furnaces draining pumps valves or lines and crackers BTX processes
- Lock smith



Key Features

- **Robust PU coating:** EN level 4/ANSI level 6 abrasion resistance
- **Lightweight liner:** Comfortable PPE gloves and exceptional dexterity
- **INTERCEPT™ Cut Resistance:** For improved workplace safety

Vulcanization Chemical Accelerators

- Natural rubber proteins (in knitwrist elastic)

Only a very small number of users may be sensitive to this ingredient(s) and hence may develop irritant and/or allergic contact reactions .

Performance Standards & Regulatory Compliance

REACH Compliant



Technologies



INTERCEPT™
Cut Resistance Technology

Specifications

BRAND STYLE	DESCRIPTION	Gauge	SIZE	LENGTH	COLOR	PACKAGE
HyFlex® 11-724	Finishing: Palm Coated Coating Material: Polyurethane Liner Material: HPPE, Spandex Cuff Style: Knitwrist	13	9, 10	208-261mm; 8.46-10.39in	Black	• 12 pairs in a bag; 12 bags in a carton

CODE	DESCRIPTION
ANSELL-80-658 SIZE: 9	80-658-Natural rubber dipped coating on a Kevlar® / metal wire / fiber glass liner. 3/4 dipped. Extended knitwrist. Length 260- 295 mm (10-12 inch). Heather green/blue

ACTIVARMR®
PERSONAL PROTECTIVE GEAR

80-658

Heavy duty cut-resistant style with excellent grip and heat protection

Previously known as: Powerflex8® O-658

High-performance protective gloves, combining cut and heat resistance with excellent grip



Cut



Heat



Heavy Duty

Industries

- Construction
- Glass manufacturing
- Metal fabrication
- Recycling and Waste Disposal

Applications

- Heavy duty handling: where sensitivity is also required
- Handling jagged metal
- Handling of glass sheets, sharp edged objects
- Handling of metal sheets, cutting of dry, painted or galvanised pieces



Key Features

- **Three-layer construction:** Added cut, splinter and burn resistance
- **Latex coating with crinkled finish:** Firm dry and wet grip
- **Extra-long cuff:** For work gloves offering forearm and wrist protection

Vulcanization Chemical Accelerators

- Natural rubber proteins (in the coating and in the elastic cuff)
- Zinc Diethyldithiocarbamate

Only a very small number of users may be sensitive to this ingredient(s) and hence may develop irritant and/or allergic contact reactions .

Performance Standards & Regulatory Compliance

REACH Compliant



0493



XX43E



X2XXX X

Technologies

Kevlar®

Specifications

BRAND STYLE	DESCRIPTION	Gauge	SIZE	LENGTH	COLOR	PACKAGE
ActivArmR® 80-658	Finishing: Dipped Coating Material: Natural Latex Rubber Liner Material: Stainless steel, Nylon, Fiber glass, Cotton, Kevlar® Cuff Style: Extra Long	7	9	250-300 mm; 9.84-11.81 inches	Blue	• 12 pairs/bag; 6 bags/carton

CODE	DESCRIPTION
ANSELL-80-100 SIZE: 9, 10, 11	80-100-Natural rubber dipped coating on a seamless polyester / cotton liner. Palm coated. Knitwrist. Length 250-280 mm (10 inch). Blue and Grey

ACTIVARMR®
PERSONAL PROTECTIVE GEAR

80-100

Designed for use in a wide range of handling and carrying applications

Previously known as: Powerflex8® O-100

Durable multi-purpose gloves, combining mechanical performance with excellent grip

Industries

- Machinery and Equipment

Applications

- Seizing rough blocs and cylinders
- Seizing and finishing structural parts
- Loading and unloading rough parts or boxes
- Picking parts and accessories
- Final assembly
- Loading raw material
- Unloading worked parts



Multi Purpose



Heavy Duty

Key Features

- **Crinkle finish coating:** Excellent grip gloves in both dry and wet conditions
- **Tough natural rubber latex design:** For abrasion-resistant gloves
- **Knitted liner and tensioned inner surface:** Superb fit and flexibility

Vulcanization Chemical Accelerators

- Natural rubber proteins
- Zinc Dibutyldithiocarbamate
- Zinc Diethyldithiocarbamate

Only a very small number of users may be sensitive to this ingredient(s) and hence may develop irritant and/or allergic contact reactions.

Performance Standards & Regulatory Compliance

REACH Compliant



Specifications

BRAND STYLE	DESCRIPTION	Gauge	SIZE	LENGTH	COLOR	PACKAGE
ActivArm® 80-100	Finishing: Palm Coated Coating Material: Natural Latex Rubber Liner Material: Cotton, Polyester Cuff Style: Knitwrist	10	9, 10, 11	235 - 280 mm/ 9.25-11.02 inches	Blue	• 12 pairs in a bag, 12 bags in a carton

CODE	DESCRIPTION
ASELL-472-400 SIZE: 9	72-400-Seamless stainless steel/glass fiber/cotton liner. Medium duty. Ambidextrous. 10 gauge. Knitwrist. Length 230-267 mm. Blue



72-400

Outstanding Mechanical Protection

Previously known as: VersaTouch® 2-400

Durable medium-duty food processing gloves, delivering advanced cut resistance with a secure fit



Cut



Cold



Medium Duty

Industries

- Food Processing

Applications

- Defeathering and skinning
- Slicing, cutting and shopping
- Steaming, frying and roasting
- Marinating
- Storing packed meats
- Storing and transportation
- Equipment maintenance and repair

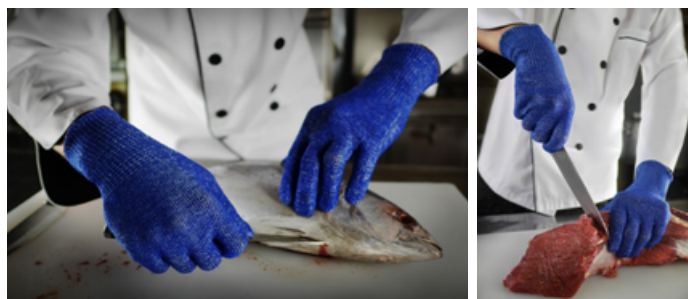

Key Features

- Fiber glass- and stainless steel-infused liner** : Superb cut resistance
- Light/mediumweight, durable design**: Flexible comfort, long wear life
- Ambidextrous spandex design**: Everyday practicality and a secure fit

Performance Standards & Regulatory Compliance

REACH Compliant

EN388: 2016



3X4XF



Specifications

BRAND STYLE	DESCRIPTION	Gauge	SIZE	LENGTH	PACKAGE
HyFlex® 72-400L	Liner Material: Fiber glass, Stainless steel, HPPE, Polyester, Lycra® Cuff Style: Knitwrist	10	9	260-267 mm, 10"-10.5"	<ul style="list-style-type: none"> 12 pieces in a bag; 2 bags in a carton

CODE	DESCRIPTION
ANSELL-76-200 SIZE: 9	76-200-Light weight nylon. Spandex wrist elastic. Length 190-235 mm (7-9 inch). White

EDGE[®]
INDUSTRIAL WORK GLOVES

76-200

Soft and comfortable seamless glove for longer and more comfortable wear

Previously known as: Stringknits™76-200

Light, stretchy gloves available in various materials and finishes

- Stringknit construction allows good air flow to the hand.
- Due to its cotton liner this glove offers softness and comfortability



Multi Purpose



Light Duty

NYLON



Industries

- Automotive
- Automotive Aftermarket
- Machinery and Equipment
- Transportation
- Recycling and Waste Disposal

Applications

- Inspection (picking, checking and marking)
- Delivery of parts to production line
- Production line support & maintenance
- General Purpose Auto Aftermarket
- Body painting including surface inspection
- Storing packed meats
- Storing bottles and cans
- Storing of raw materials
- Loading and unloading rough parts or boxes
- Picking parts and accessories

Key Features

- Seamless glove for a longer and more comfortable wear. Can be worn on their own or as liners
- Ambidextrous. No need to pair, therefore more economical
- All styles washable at 40°C. Will not shrink, stiffen or lose their shape. More hygienic for the wearer. Better value for the provider

Performance Standards & Regulatory Compliance

REACH Compliant



214XA

Specifications

BRAND STYLE	DESCRIPTION	Gauge	SIZE	LENGTH	PACKAGE
EDGE 76-200L	Liner Material: Nylon Cuff Style: Knitwrist	13	9	180-240 mm	• 12 pairs/bag, 12 bags/carton

CODE	DESCRIPTION
ANSELL-76-100 SIZE: 9	76-100-Light weight cotton. Length 215-235 mm (8-9 inch). Natural Colour

EDGE[®]
INDUSTRIAL WORK GLOVES

76-100

Light, stretchy gloves available in various materials and finishes

Previously known as: Stringknits™76-100

Light, stretchy gloves available in various materials and finishes



Multi Purpose



Light Duty

- Glove construction allows good air flow to the hand.
- Due to its cotton liner this glove offers softness and comfort.

Industries

- Automotive
- Automotive Aftermarket
- Machinery and Equipment
- Recycling and Waste Disposal
- Transportation

Applications

- Delivery of parts to production line
- Delivery of vehicles to expedition area
- Loading and unloading rough parts or boxes

COTTON



Key Features

- Seamless glove for a longer and more comfortable wear. Can be worn on their own or as liners
- Ambidextrous. No need to pair, therefore more economical
- All styles washable at 40°C. Will not shrink, stiffen or lose their shape. More hygienic for the wearer. Better value for the provider

Vulcanization Chemical Accelerators

- Natural rubber proteins

Only a very small number of users may be sensitive to this ingredient(s) and hence may develop irritant and/or allergic contact reactions .

Performance Standards & Regulatory Compliance

REACH Compliant



002X A

Specifications

BRAND STYLE	DESCRIPTION	Gauge	SIZE	LENGTH	PACKAGE
EDGE [®] 76-100L	Liner Material: Cotton Cuff Style: Knitwrist	13	9	214-235 mm	• 12 pairs/bag, 12 bags/carton

CODE	DESCRIPTION
ANSELL-47-400 SIZE: 9, 10	47-400-Palm coated. Knitwrist. Length 270 mm (11 inch). Blue

ACTIVARMR®
PERSONAL PROTECTIVE GEAR

47-400

Comfortable oil-repellent glove for medium duty tasks

Previously known as: Hylite™

A versatile alternative to cotton, light leather and PVC gloves



Oil



Medium Duty

Industries

- Automotive
- Machinery and Equipment
- Metal fabrication

Applications

- Handling metal sheets & panels
- Chassis assembly, body trimmign
- Final assembly
- Inspection (picking, checking and marking)
- Cutting glasses, sheets, panels
- Fabricating metal parts, glass sheets
- Assembly & inspection of components



Key Features

- For extra comfort, ActivArm® Hylite™ gloves feature interlock knit lining, generous sizing, and contoured designs
- Special nitrile formulation provides an excellent combination of flexibility, mechanical resistance and oil repellency
- Natural hand shape - easier to wear for long periods
- Available in a wide range of styles, lengths and sizes
- Silicone-free. Ensures cleanliness of metal sheets: important in steel and motor industries

Performance Standards & Regulatory Compliance

REACH Compliant



3111 A

Specifications

BRAND STYLE	DESCRIPTION	Gauge	SIZE	LENGTH	COLOR	PACKAGE
ActivArm® Hylite™ 47-400	Finishing: □ Dipped Coating Material: Nitrile Liner Material: Interlock cotton Cuff Style: Knitwrist	N/A	9, 10	265-295 mm; 10.74-11.37 inches	Blue	• 12 pairs in a bag; 12 bags in a carton

CODE	DESCRIPTION
ANSELL-27-805 SIZE: 10	27-805-Fully coated. Safety cuff. Length 250-260 mm (10 inch). Blue

ACTIVARMR®
Hycron®

27-805

A big tough glove for a rough tough life



Oil



Heavy Duty

Heavy-duty nitrile-coated gloves with a jersey liner, for robust all-round hand protection

Industries

- Automotive
- Machinery and Equipment
- Metal fabrication
- Chemical

Applications

- Handling metal sheets & panels
- Metalworking & assembly operations
- Press injection molding
- Seizing and finishing structural parts
- Fixing, clipping parts and wire harnesses; connecting devices
- Assembly & inspection of components
- Opening furnaces draining pumps valves or lines and crackers BTX process



Key Features

- **Unique nitrile formulation:** Tough, hardy abrasion resistance*
- **Cotton jersey liner:** For protective gloves that ensure optimal comfort
- **Silicone-free design:** Suitably clean for metal and motor manufacture
*3x greater durability than standard leather alternatives

Performance Standards & Regulatory Compliance

REACH Compliant



4121B

Specifications

BRAND STYLE	DESCRIPTION	Gauge	SIZE	LENGTH	COLOR	PACKAGE
ActivArm® Hycron 27-805F	Finishing: Fully Coated Coating Material: Nitrile Liner Material: Cotton Jersey Cuff Style: Safety Cuff		10	256-272 mm/ 10.08-10.71 inches	Blue	• 12 pairs in a bag; 12 bags in a carton

CODE	DESCRIPTION
ANSSELL-48-216 SIZE: 10	48-216-Split cowhide natural leather outside. Cotton liner. Aramid seams, gauntlet cuff. Length 360 mm. Grey

EDGE®
INDUSTRIAL WORK GLOVES

48-216

Cost-efficient solution for demanding welding application

High levels of durability, control and protection from heat, flame, sparks and puncture



Heat



Heavy Duty

Industries

- Automotive
- Construction
- Machinery and Equipment
- Metal fabrication
- Oil and gas
- Mining

Applications

- Brazing
- Handling hot metal castings
- Grinding
- Welding
- Handling of metal sheets, cutting of dry, painted or galvanised pieces



Key Features

- EDGE® Glove is CE certified and complying with REACH European regulation
- Glove total length of 36 cm provide a full forearm protection
- Can be ideally combined with Ansell Welding Sleeve 59-416, made of Lenzing FR® and Kevlar

Performance Standards & Regulatory Compliance

REACH Compliant



0493



4133B



4133B



413X4X

Specifications

BRAND STYLE	DESCRIPTION	Gauge	SIZE	LENGTH	PACKAGE
EDGE® 48-216	Liner Material: Cotton Cuff Style: Gauntlet	N/A	10	360 mm; 14.17 inches	• 6 pairs/bag; 6 bags/carton

CODE	DESCRIPTION
ANSELL-43-216 SIZE: 10	43-216-Leather gauntlet. Length 410 mm (16 inch). Yellow

ACTIVARMR®
PERSONAL PROTECTIVE GEAR

43-216

Heavy-duty welding glove for demanding welding and thermal job tasks

Previously known as: ActivArm® Workguard™ 43-216



Heat



Welding



Heavy Duty

Heat-resistant industrial gloves, fortified for advanced hand protection in demanding tasks

Industries

- Automotive
- Machinery and Equipment
- Metal fabrication
- Automotive Aftermarket
- Oil and gas



Applications

- Welding, bonding, riveting
- Metalworking & assembly operations
- Equipment repair & maintenance

Key Features

- **Three-dimensional thumb design:** Enhanced dexterity and control
- **Premium leather and Kevlar® sewn welted seams:** Durability and comfort
- **Long cuffs with cotton liner:** Increased forearm and wrist protection

Technologies

Kevlar®

Performance Standards & Regulatory Compliance

REACH Compliant



0493



3243B



413X4 X

Specifications

BRAND STYLE	DESCRIPTION	Gauge	SIZE	LENGTH	PACKAGE
ActivArm® 43-216	Liner Material: Split cowhide leather, Cotton, Kevlar Cuff Style: Gauntlet	N/A	10	370-415 mm; 14.6-16.3 inches	• 6 pair/bag; 6 bags/carton

CODE	DESCRIPTION
ANSELL-11-280 SIZE: 16	Heightened defenses: INTERCEPT™ Cut Resistance Technology's blend of synthetic and natural fibers ensures superior protection, especially when combined with HyFlex® cut-resistant gloves



11-280

High cut protection sleeve with excellent breathability

Our best Cut Sleeves, now made green



Cut



Medium Duty

- **Heightened defenses:** INTERCEPT™ Cut Resistance Technology's blend of synthetic and natural fibers ensures superior protection, especially when combined with HyFlex® cut-resistant gloves
- **Elevated comfort:** HyFlex® 11-280 protective arm sleeves also deliver superb comfort, with a seamless design and HPPE yarn that ensures a cool, breathable feel
- **Food handling compliance:** They adhere to FDA food handling regulations 21 CFR 177.1520 and 21 CFR 177.2600, for safe food handling and compliant workplace safety
- **Varied sizing options:** HyFlex® 11-280 sleeves come in wide and narrow versions, with multiple length options
- **Certified harm-free:** They also benefit from Oeko-Tex® certification, certifying them free of substances harmful to human health
- **Sustainable design:** HyFlex® 11-280 sustainable sleeves are designed with 20% recycled content* reducing our carbon footprint by 47g CO2eq/piece**



Industries

- Automotive
- Machinery and Equipment
- Metal fabrication
- Automotive Aftermarket
- Food Processing
- Utilities
- Warehousing

Applications

- Glass repair and replacement
- Handling metal sheets & panels

Technologies



Performance Standards & Regulatory Compliance











Specifications

BRAND STYLE	DESCRIPTION	Gauge	LENGTH	PACKAGE
HyFlex® 11-280	Liner Material: Ansell INTERCEPT™ Technology Cuff Style: Knitwrist without thumbslot	15	12" (30 CM), 16" (40 CM), 18" (45 CM), 22" (55 CM)	50 sleeves/carton

CODE	DESCRIPTION
ANSELL-59-416 ONE SIZE	Medium-duty welding arm sleeves, providing protection against heat, burns and cuts

59-416

Heat and cut-resistant protective sleeves for welders

Medium-duty welding arm sleeves, providing protection against heat, burns and cuts

Previously known as: Safe-Knit

- **Specialized protection:** ActivArmr® 59-416 heat- and cut-resistant sleeves feature Kevlar® fabric, satisfying EN ISO B cut protection standards while guarding against heat, molten particles and sparks
- **Increased comfort:** These protective arm sleeves are also designed with a cotton internal layer that is both lightweight and breathable, which ensures sustained comfort for wearers

- Industries**
- Automotive
 - Metal fabrication

- Applications**
- Press shop operations
 - Handling metal sheets & panels
 - Handling parts with sharp, rough edges
 - Welding, bonding, riveting
 - Handling structural and body components
 - Inspection, selecting, checking parts
 - Processing sheets, coils, tubes
 - Cutting glasses, sheets, panels
 - Handling parts in high heat areas

- Key Features**
- **Kevlar® fabric:** Personal protection from molten particles and sparks
 - **Internal cotton layer:** Lightweight, breathable comfort
- Vulcanization Chemical Accelerators**
- Natural rubber proteins

Only a very small number of users may be sensitive to this ingredient(s) and hence may develop irritant and/or allergic contact reactions.

Performance Standards & Regulatory Compliance



Specifications

BRAND STYLE	DESCRIPTION	Gauge	SIZE	LENGTH	PACKAGE
ActivArmr® 59-416	Liner Material: Kevlar®, Cotton Cuff Style: Sleeve		One Size	26" (66 cm)	12 pieces/bag, 3 bags/carton



CHEMICAL AND LIQUID PROTECTION



Industries

- Agriculture
- Automotive
- Chemical
- Food Processing
- Life Sciences
- Machinery and Equipment
- Metal fabrication
- Oil and gas
- Recycling and Waste Disposal
- Janitorial / Sanitation
- Utilities
- Warehousing

CODE	DESCRIPTION
ANSELL-87-955 SIZE: 9, 10	87-955-Heavy weight. Lozenge. Flocked. Chlorinated. Pair-packed. Thickness +/- 0.75 mm (30 mil). Length 320 mm (13 inch). Orange.

AlphaTec®

ADVANCED CHEMICAL PROTECTION

87-955

Extra heavy duty natural rubber glove with flocked lining

Previously known as: Extra 87-955

Industries

- Construction
- Machinery and Equipment
- Infrastructure Maintenance
- Chemical

Applications

- Chemical processing and preparation
- Maintenance of plant and heavy equipment
- Janitorial use

Thicker natural rubber latex glove for extra protection in heavy duty applications



Key Features

- Extra heavy duty orange glove
- Heavy duty with 0.73 mm / 29 mils thickness
- 100% cotton flock lining

Vulcanization Chemical Accelerators

- Natural rubber proteins
- Zinc Diethyldithiocarbamate

Only a very small number of users may be sensitive to this ingredient(s) and hence may develop irritant and/or allergic contact reactions .

Performance Standards

CE 0493



Specifications

BRAND STYLE	DESCRIPTION	SIZE	LENGTH	COLOR	PACKAGE
AlphaTec® 87-955	Cotton Flocking, Natural Latex Rubber,	9, 10	325 / 12.8	Orange	• 1 pair per inner bag, 12 inner bags per master bag, 12 master bags per carton

CODE	DESCRIPTION
ANSELL-37-310 SIZE: 8, 9	37-310-Unsupported nitrile. Unflocked, Lozenge grip, length 310mm, thickness 0.2mm, Blue

AlphaTec®
ADVANCED CHEMICAL PROTECTION

37-310

Improved grip, dexterity and flexibility

Thin, yet durable, food processing gloves, offering light chemical protection

Industries

- Food Processing
- Janitorial / Sanitation
- Agriculture
- Chemical
- Utilities
- Warehousing



Applications

- Dairy Processing
- Fruit and Vegetable Processing
- Prepared Meals
- Janitorial use
- Cleaning

Key Features

- **Unflocked and latex-free:** Reduced risk of contamination and allergens
- **Extra-thin 8 mil/0.2mm palm:** For PPE gloves with advanced dexterity
- **Food handling certification:** Safety gloves ideal for food processing



Performance Standards

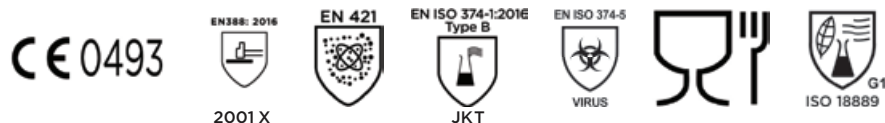

Specifications

BRAND STYLE	DESCRIPTION	SIZE	LENGTH	COLOR	PACKAGE
AlphaTec® 37-310N	/A, Nitrile,	8, 9	310 / 12.2	Blue	<ul style="list-style-type: none"> • 12 pairs in a bag; 12 bags in a carton • polybag weight = 20g • shipper carton = 0.6kg • IFU = 100g

CODE	DESCRIPTION
ANSELL-37-376 SIZE: 9, 10	37-676-Flocked. Reversed Lozenge. Thickness 0.43 mm. Length 330 mm (13 inch). Green

AlphaTec®
Solvex®

37-676

Excellent chemical protection with a good level of grip, fit and comfort

Previously known as: Solvex® 37-676

Comfortable chemical-resistant gloves, delivering highly durable personal protection

Applications

- Delivery of parts to production line
- All food processing applications that have food contact
- Forging operations
- General pumping work
- Handling incoming goods
- Filling, blending and charging of raw materials
- Opening and draining pumps valves or lines
- Loading and unloading of process equipment
- Transferring liquids and solids between vessels and tanks and process equipment
- Supervision of running operation
- Handling outgoing goods: cans, vessels, bulkpack and cartons
- Testing
- Opening furnaces draining pumps valves or lines and crackers BTX process
- Painting or cleaning tools or robots

Industries

- Automotive
- Food Processing
- Metal fabrication
- Oil and gas
- Chemical
- Agriculture
- Automotive Aftermarket
- Utilities
- Warehousing



Key Features

- **Cotton flocking:** Moisture absorbency, for improved wearer comfort
- **Reversed lozenge finish:** Enhanced grip, for safer handling
- **Tough nitrile compound:** Heightened durability and chemical defenses



Performance Standards



Specifications

BRAND STYLE	DESCRIPTION	SIZE	LENGTH	COLOR	PACKAGE
AlphaTec® Solvex 37-676	Cotton Flocking, Nitrile ,	9, 10, 11	330 / 13	Green	<ul style="list-style-type: none"> • 12 pairs per bag, 12 bags per carton • Vend pack variant, 6 pairs per bag, 24 bags per carton

CODE	DESCRIPTION
ANSELL-58-005 SIZE: 9, 10	58-005-Seamless dipped highly ergonomic glove. Nitrile/Neoprene coating on a nylon liner. ANSELL GRIP Technology™. Gauntlet. Green. Length 356 mm (14 inch)

AlphaTec®

ADVANCED CHEMICAL PROTECTION

58-005

Ergonomic, Comfortable Chemical protection

Industries

- Agriculture
- Automotive
- Chemical
- Food Processing
- Life Sciences
- Machinery and Equipment
- Metal fabrication
- Oil and gas
- Recycling and Waste Disposal

Applications

- Assembly & inspection of components
- Oil, fluids and filter change
- Painting or cleaning tools or robots
- Handling incoming goods
- Transferring liquids and solids between vessels and tanks and process equipment
- Transferring liquids and solids
- Opening furnaces draining pumps valves or lines and crackers BTX process
- Cleaning furnaces, distillation pumps, valves or lines and crackers BTX process
- Opening and draining pumps valves or lines

Don't sacrifice on Comfort, Fit and Ergonomics whilst performing your critical chemical handling tasks



Key Features

- Optimized fit that integrates the nylon liner into the nitrile and neoprene shell for better dexterity & tactility versus double gloving
- Excellent dry & wet grip enhance dexterity and reduce hand fatigue
- Cuff can be folded to act as a gutter to prevent chemicals running down the arm

Technologies



Performance Standards



Specifications

BRAND STYLE	DESCRIPTION	SIZE	LENGTH	COLOR	PACKAGE
AlphaTec® 58-005	Nylon, Neoprene and Nitrile, ANSELL GRIP™	9, 10	350 / 13.8	Green	• 6 pairs per bag, 12 bags per carton

CODE	DESCRIPTION
ANSELL-58-128 SIZE: 9, 10	58-128-Fully coated gauntlet. Ansell Grip Technology™. Length 280 mm (11 inch). Green with anthracite hand. 18 gauge. White nylon liner

AlphaTec®

ADVANCED CHEMICAL PROTECTION

58-128

Nitrile glove with second skin fit

Industries

- Automotive
- Automotive Aftermarket
- Machinery and Equipment
- Metal fabrication
- Chemical

Applications

- Body painting including surface inspection
- Applying sealers, touching up
- Press injection molding
- Equipment repair & maintenance
- Assembling and mounting components
- Painting or cleaning tools or robots
- Final assembly
- Metalwork, glass processing
- Assembly & inspection of components
- Warehousing of raw materials
- Testing

Enhanced Dexterity with Light Duty Chemical Protection and ANSELL GRIP Technology™



Key Features

- The first ergonomically certified chemical glove
- Provides quantifiable ergonomic benefits to the wearer
- Delivers high-performance musculoskeletal support
- Conforms to the shape of the wearer's hand enabling natural movement
- Maximizes worker productivity by minimizing hand fatigue and discomfort
- Reduces the risk of ergonomic injury caused by prolonged or repetitive manual tasks

Vulcanization Chemical Accelerators

- Zinc Diethyldithiocarbamate

Only a very small number of users may be sensitive to this ingredient(s) and hence may develop irritant and/or allergic contact reactions.

Performance Standards



Technologies



Specifications

BRAND STYLE	DESCRIPTION	SIZE	LENGTH	COLOR	PACKAGE
AlphaTec® 58-128	Nylon, Nitrile, ANSELL GRIP™	9, 10	280 / 11	Grey	• 12 pairs/polybag; 12 polybags/carton

CODE	DESCRIPTION
ANSELL-87-195 SIZE: 8, 9	87-195-Ultra light weight. Flocked. Chlorinated. Fishscale. Pair-packed. Thickness +/- 0.35 mm. Length 305 mm (12 inch). Blue

AlphaTec®

ADVANCED CHEMICAL PROTECTION

87-195

Extra lightweight natural rubber glove with flocked lining

Previously known as: VersaTouch® 87-195

Industries

- Janitorial / Sanitation
- Food Processing
- Agriculture
- Chemical

Applications

- Cleaning
- All food processing applications that have food contact
- Fruit and Vegetable Processing
- Laboratory maintenance and clean up
- Janitorial use

Ultralight, highly tactile food processing gloves, specially treated to reduce allergy risks



Key Features

- **Food handling certification:** For EU- and FDA-certified PPE gloves
- **Treated natural rubber:** Reduced risk of allergic reactions
- **Cotton flocking:** Moisture absorbency, for comfortable hand protection

Vulcanization Chemical Accelerators

- Natural rubber proteins
- Zinc Diethyldithiocarbamate

Only a very small number of users may be sensitive to this ingredient(s) and hence may develop irritant and/or allergic contact reactions .

Performance Standards

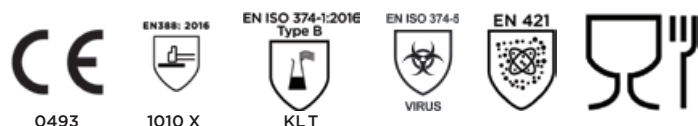

Specifications

BRAND STYLE	DESCRIPTION	SIZE	LENGTH	COLOR	PACKAGE
AlphaTec® 87-195	Cotton Flocking, Natural Latex Rubber,	8, 9	305 / 12	Blue	• 1 pair per inner bag, 12 inner bags per master bag, 12 master bags per carton



GENERAL DISPOSABLE SINGLE USE



Industries

- Healthcare
- Automotive
- Food Processing
- Food Service
- Janitorial / Sanitation
- Manufacturing
- Life Sciences
- Government
- Machinery and Equipment
- Chemical
- Agriculture
- Utilities
- Warehousing
- Cosmetics
- Tattoo
- Automotive Aftermarket
- Dental
- Emergency Medical Services
- Metal fabrication

CODE	DESCRIPTION
ANSELL-92-134 SIZE: S, M, L, XL, XXL	92-134-Thin blue nitrile glove. PPE and MD certified. Length: 240mm. Thickness: 0.07mm. Powder-free. Textured fingertips

MICROFLEX
ADVANCED DISPOSABLE HAND PROTECTION

92-134

Nitrile Exam Glove with Textured Fingers

Offers tactility and comfortable protection across numerous applications



- Made of a soft nitrile formulation for comfortable fit and feel
- Lightweight construction for tactile sensitivity and fine motor control
- Designed for a broad range of applications across all industries
- Textured on the fingertips for secure handling of tools and materials



SINGLE USE / ΜΙΑΣ ΧΡΗΣΗΣ

Industries

- Healthcare
- Automotive
- Food Processing
- Janitorial / Sanitation
- Manufacturing
- Life Sciences
- Government

Recommended For

- Standard patient examinations
- Picking parts and accessories
- Food processing and handling
- Catering/Meal preparation
- Disposal of waste (trash, biohazard and linens)
- Light assembly tasks
- Lab work, blending, compounding, filling, cleaning
- Preparing pharmaceutical products
- Laboratory analysis



PHYSICAL PROPERTIES

	Typical Values		Testing Method
Length (mm/inches)	240 / 9.5		ASTM D6319
Freedom from Holes (Inspection level)	1.5 AQL		ASTM D5151
Palm Thickness (mm/mils)	0.07 / 2.8		ASTM D6319
Finger Thickness (mm/mils)	0.11 / 4.3		ASTM D6319
	BEFORE AGING	AFTER AGING	
Ultimate Tensile Strength (MPa)	≥ 14	≥ 14	ASTM D412 & D573
Elongation at Break (%)	≥ 500	≥ 400	ASTM D412 & D573
Force at break (N)	≥ 6	≥ 6	EN 455-2

ORDERING INFORMATION

Size	S (6.5 - 7)	M (7.5 - 8)	L (8.5 - 9)	XL (9.5 - 10)	XXL
Product Code	921340709	21340809	2134090	92134100	

Performance Standards and Regulatory Compliance



CODE	DESCRIPTION
ANSELL-93-732 SIZE: S, M, L, XL, XXL	93-732-Thin black nitrile with an ergonomic construction. Silicone free. Textured fingertips for a secure grip. Thickness: 0.07mm. Length: 240mm.

MICROFLEX
ADVANCED DISPOSABLE HAND PROTECTION

93-732

Ergonomically designed thin Black Nitrile exam glove

Provides excellent dexterity along with enhanced comfort fit and feel



- Enhanced dexterity and tactility in a thin, yet strong design
- Distinctive black color provides contrast while also hiding the appearance of oils, bodily fluids and other stains
- ERGOFORM™ Design Technology reduces muscle strain during repetitive tasks, improving worker comfort and productivity
- Textured on the fingertips for secure handling of instruments and materials



SINGLE USE / ΜΙΑΣ ΧΡΗΣΗΣ

Industries

- Food Service
- Cosmetics
- Tattoo
- Automotive Aftermarket
- Chemical
- Emergency Medical Services
- Healthcare
- Law Enforcement
- Life Sciences
- Dental
- Machinery and Equipment
- Metal fabrication

Recommended For

- General dentistry
- Standard patient examinations
- Emergency services
- Catering/Meal preparation
- General Purpose Auto Aftermarket
- Equipment repair and maintenance
- Laboratory analysis
- Cosmetic Procedures
- Tattoo



PHYSICAL PROPERTIES

	Typical Values		Testing Method
Length (mm/inches)	245 / 9.6		ASTM D6319, EN 455-2
Freedom from Holes (Inspection level)	1.5 AQL		ASTM D5151, EN 455-1
Palm Thickness (mm/mils)	0.07 / 2.8		ASTM D6319, EN 455-2
Finger Thickness (mm/mil)±0	.11 / 4.3		ASTM D6319, EN 455-2
	BEFORE AGING	AFTER AGING	
Ultimate Tensile Strength (MPa)	≥ 18	≥ 16	ASTM D412 & D573
Elongation at Break (%)	≥ 500	≥ 400	ASTM D412 & D573
Force at break (N)	≥ 6	≥ 6	EN 455

ORDERING INFORMATION

Size	S (6.5 - 7)	M (7.5 - 8)	L (8.5 - 9)	XL (9.5 - 10)	XXL
Product Code	93732070	93732080	93732090	93732100	

Technology



Performance Standards and Regulatory Compliance



CODE	DESCRIPTION
ANSELL-93-256 SIZE: M, L, XL, XXL	Nitrile disposable gloves that provide confident grip and durable protection

MICROFLEX
ADVANCED DISPOSABLE HAND PROTECTION

Mega Texture 93-256

Orange Short Cuff Nitrile Disposable Glove with Raised Grip

Nitrile disposable gloves that provide confident grip and durable protection

- **Enhanced grip:** Featuring our Mega Texture surface for consistent grip in wet and dry conditions
- **Tear resistance:** Robust 0.13mm/5.1mil palm thickness to resist tearing in use
- **High visibility:** Orange color to increase visibility while working
- **Durable:** Strong formulation providing durable yet comfortable hand protection
- **Food approved:** Ideal for a wide range of food handling applications



Industries

- Automotive
- Automotive Aftermarket
- Food Processing
- Machinery and Equipment
- Maintenance
- Manufacturing
- Recycling and Waste Disposal
- Transportation

Recommended For

- General Purpose Auto Aftermarket
- Food processing and handling
- Oil, fluids and filter change
- Engine transmission and repair
- Mechanical jobs
- Maintenance
- Tire rotation & changes
- Vehicle maintenance
- Assembly of parts

TECHNICAL DATA SHEET

	Product Information
External Glove Surface	Fully Textured
Audit Standards	ISO 13485, ISO 9001
Product Certification	Arrette du 05/08/2020, EU Food Contact Approved, EC 2023/2006, ASTM D6319, CE 0493, EN ISO 21420:2020, EN ISO 374-1:2016+A1:2018 Type B JKPT, EN ISO 374-5:2016, FDA21 CFR 177-2600-US Food Contact Approved, ISO 13485, ISO 9001, ISO 18889:2019 G1, UKCA
Packaging Overview	100 gloves per dispenser 10 dispensers per case 1000 gloves per case
Storage Instructions	Keep out of direct sunlight; store in a cool and dry place. Keep away from sources of ozone or ignition.
Country Of Origin	Thailand
Product Segmentation	Robust
Antistatic	Yes
Silicone Free	No

PHYSICAL PROPERTIES

	Typical Values		Testing Method
Length (mm/inches)	240/9.45		ASTM D6319,ASTM D3767
Freedom from Holes (Inspection level I)	1.5 AQL		ASTM D5151,EN 455-1,EN 374-2
Palm Thickness (mm/mils)	0.13/5.1		ASTM D6319,ASTM D3767
Finger Thickness (mm/mils)	0.16/6.3		ASTM D6319,ASTM D3767
	BEFORE AGING	AFTER AGING	
Ultimate Tensile Strength (MPa)	≥ 14	≥ 14	ASTM D412 & D573
Elongation at Break (%)	≥500	≥400	ASTM D412 & D573
Force at break (N)	≥6	≥6	EN 455-2

ORDERING INFORMATION

Size	S (6.5 - 7)	M (7.5 - 8)	L (8.5 - 9)	XL (9.5 - 10)	XXL (10.5 - 11)
Product Code	93256070	93256080	93256090	93256100	93256110

Performance Standards and Regulatory Compliance



CODE	DESCRIPTION
ANSELL-93-852 SIZE: S, M, L, XL	93-852-Ambidextrous Nitrile. Single Use, Powderfree. Thickness 0.12mm. Length 245mm. Black

MICROFLEX
ADVANCED DISPOSABLE HAND PROTECTION

93-852

Distinctive, Black Nitrile Exam Glove



Distinct black color to mask stains

- Non-foaming for easy handling of objects in wet environments
- Distinctive black color hides stains and provides contrast for improved visibility
- Fully textured design for confident grip



SINGLE USE / ΜΙΑΣ ΧΡΗΣΗΣ

Industries

- Automotive
- Automotive Aftermarket
- Life Sciences
- Machinery and Equipment

Recommended For

- Inspection, selecting, checking parts
- General Purpose Auto Aftermarket
- Use of cleaning tools and robotic equipment
- Oil, fluids and filter change
- Engine transmission and repair
- Tire rotation & changes
- Maintaining lab furniture and equipment
- Sample taking and processing
- Blending, compounding solids and liquids
- Raw material sample collection
- Weighing and dispensing of solid and liquid raw materials
- Inspection (picking, checking and marking)



PHYSICAL PROPERTIES

	Typical Values		Testing Method
Length (mm/inches)	245 / 9.6		ASTM D3767, EN 420
Freedom from Holes (Inspection level)	1.5 AQL		ASTM D5151, EN 455-2
Palm Thickness (mm/mils) @ 0	.12 / 4.7		ASTM D3767, EN 420
Finger Thickness (mm/mils)	0.15 / 5.9		ASTM D3767, EN 420
	BEFORE AGING	AFTER AGING	
Ultimate Tensile Strength (MPa)	24	20	ASTM D412 & D573
Elongation at Break (%)	6005	00	ASTM D412
Force at break (N)7		6	EN 455-2

ORDERING INFORMATION

Size	S (6.5 - 7)	M (7.5 - 8)	L (8.5 - 9)	XL (9.5 - 10)
Product Code	938520709	38520809	3852090	93852100

Performance Standards and Regulatory Compliance



CODE	DESCRIPTION
ANSELL-92-600 SIZE: S, M, L, XL	92-600-Ambidextrous Nitrile. Single-use. Powderfree. Thickness 0.12 mm. Length 240 mm (9 inch). Green.

TouchNTuff®
ADVANCED PRODUCT & WORKER PROTECTION

92-600

Disposable Nitrile Glove with Enhanced Chemical Splash Protection

An unparalleled combination of chemical splash protection, comfort and durability



- The world's leading disposable glove for chemical splash protection
- Made with TNT Chemical Splash Resistance Technology for superior protection against harmful chemical splashes
- Super soft nitrile provides a comfortable, silky feel for extended wear
- Proprietary formulation provides robust durability in a softer glove
- Silicone-free design is paint and finish process friendly



SINGLE USE / ΜΙΑΣ ΧΡΗΣΗΣ

Industries

- Life Sciences
- Food Processing
- Automotive
- Machinery and Equipment
- Chemical
- Agriculture
- Utilities
- Warehousing

Recommended For

- Transferring liquids and solids
- Sample taking and processing
- Meat, Fish and Food Processing
- Industrial Production
- Maintenance
- Laboratory analysis
- Chemical Handling



PHYSICAL PROPERTIES

	Typical Values		Testing Method
Length (mm/inches)	240 / 9.5		ASTM D3767, EN 420
Freedom from Holes (Inspection level I)	4.0 AQL (North & South America) / 1.5 AQL (Europe, Middle East, Africa, Asia, Pacific)		ASTM D5151, EN 455-1
Palm Thickness (mm/mil)±0	.125 / 4.9		ASTM D3767, EN 420
Finger Thickness (mm/mil)±0	.14 / 5.5		ASTM D3767, EN 420
	BEFORE AGING	AFTER AGING	
Ultimate Tensile Strength (MPa)	≥ 18	≥ 18	ASTM D412 & D573
Elongation at Break (%)	≥ 500	≥ 400	ASTM D412
Force at break (N)	≥ 6	≥ 6	EN 455-2

ORDERING INFORMATION

Size	S (6.5 - 7)	M (7.5 - 8)	L (8.5 - 9)	XL (9.5 - 10)
Product Code	585834	585835	585836	585837
Vending Pack CatalogNº	9260000S	9260000M	9260000L	9260000XL

Technology



Performance Standards and Regulatory Compliance



CODE	DESCRIPTION
ANSELL-69-318 SIZE: M, L, XL	69-318-"Powder-free. Textured Finish. Thickness 0.12 mm. Length 240 mm. Natural Colour.

TouchNTuff®
ADVANCED PRODUCT & WORKER PROTECTION

69-318

Lightweight Latex Exam Glove with
Enhanced Tactility

Designed for comfort, tactility and gripping delicate instruments



- Soft, elastic latex material provides exceptional comfort
- Thin, lightweight design for enhanced tactile sensitivity
- Textured fingers enable easier handling of small objects and delicate tools
- Complies with FDA food handling requirements
- Also available in vend pack



SINGLE USE / ΜΙΑΣ ΧΡΗΣΗΣ

Industries

- Life Sciences
- Food Processing
- Chemical

Recommended For

- Sample taking and processing
- Testing
- Vehicle maintenance
- Food contact
- All food processing, applications that have food contact
- Food processing and handling
- Meat, Fish and Food Processing
- Secondary food processing



PHYSICAL PROPERTIES

	Typical Values		Testing Method
Length (mm/inches)	240 / 9.5		ASTM D3767, EN 420
Freedom from Holes (Inspection level)	1.5 AQL		ASTM D5151, EN 455-1
Palm Thickness (mm/mils)0	.12 / 4.7		ASTM D3767, EN 420
Finger Thickness (mm/mils)0	.14 / 5.5		ASTM D3767, EN 420
	BEFORE AGING	AFTER AGING	
Ultimate Tensile Strength (MPa)	≥ 18	≥ 14	ASTM D412 & D573
Elongation at Break (%)	≥ 650	≥ 500	ASTM D412

ORDERING INFORMATION

Size	M (7.5 - 8)	L (8.5 - 9)	XL (9.5 - 10)
Product Code	6931800M	6931800L	693180XL

Performance Standards and Regulatory Compliance



CODE	DESCRIPTION
ANSELL-93-283 SIZE: S, M, L, XL	93-283-Robust powder-free nitrile glove with a mega texture surface. Ambidextrous. Extended cuff. Thickness: 0.2mm. Length: 300mm. Blue.

MICROFLEX
ADVANCED DISPOSABLE HAND PROTECTION

93-283

Nitrile Disposable Glove with Raised Grip

Thick, 8 mil nitrile gloves that offer a comfortable, confident grip when handling wet, oily, or fatty foods and objects



SINGLE USE / ΜΙΑΣ ΧΡΗΣΗΣ

- Feature a Mega Texture surface for secure grip
- Have a Generous Fit for comfortable use with a cut-protective or thermal under gloves
- The robust 0.20mm / 8mil Thickness resists tearing, for product protection
- Are compliant with US Food Contact and EU Food Migration Regulations



Industries

- Food Processing
- Janitorial / Sanitation
- Automotive Aftermarket

Recommended For

- Packaging and labeling
- Food processing and handling
- Cold storage
- Deboning, carving
- Handling of frozen foods
- Janitorial, clean up and maintenance
- Processing meat, vegetables and dairy sanitation
- Secondary food processing



PHYSICAL PROPERTIES

	Typical Values		Testing Method
Length (mm/inches)	300 / 11.8		ASTM D3767, EN 420
Freedom from Holes (Inspection level)	1.5 AQL		ASTM D5151, EN 374-2
Palm Thickness (mm/mils)	.20 / 7.9		ASTM D3767, EN 420
Finger Thickness (mm/mils)	0.24 / 9.4		ASTM D3767, EN 420
	BEFORE AGING		AFTER AGING
Ultimate Tensile Strength (MPa)	52	3	ASTM D412 & D573
Elongation at Break (%)	500	00	ASTM D412
Force at break (N)	6>	6	EN 455-2

ORDERING INFORMATION

Size		M (7.5 - 8)	L (8.5 - 9)			
Product Code		93283080	93283090			

Performance Standards and Regulatory Compliance





CHEMICAL PROTECTIVE SUITS



Industries

- Life Sciences
- Automotive
- Metal fabrication
- Food Processing
- Chemical
- Automotive Aftermarket
- Mining
- Machinery and Equipment
- Agriculture

CODE

ANSELL-1500-WH CVRL HOOD 138
SIZE: M, L, XL, XXL, XXL

AlphaTec®
ADVANCED CHEMICAL PROTECTION

1500 - Model 138
 Breathable, SMS material, Type 5/6 protection

Previously known as: MICROGARD® 1500 PLUS - Model 138

Comfortable protection from hazardous particulates in general industrial environments.

- Protection - Proven to filter 100% of particles >3 microns*
 - Comfort - Air and water vapour permeable (breathable) to help reduce the risk of heat stress
 - Silicone Free - critical in spray painting applications
 - Optimised body fit - improves wearer comfort and safety
- * KAKEN Particle penetration test

Industries

- Machinery and Equipment
- Construction
- Chemical

Applications

- Inspection (picking, checking and marking)
- Asbestos Related Work
- Handling of powders



EN ISO 13688:2013



TYPE 5

TYPE 6

EN 1073-2

PRODUCT INFORMATION

Product Material	SMS fabric
Design Features	Coverall, 3-piece hood, elasticated hood, wrists, waist and ankles. 2-way front zipper with re-sealable storm flap.
Seam Type	Bound Seams
Standards Overview	CE CATEGORY III (Type 5, Type 6, EN 1073-2)
Product Reference	1500 - Model 138
Sizes	M, L, XL, XXL, XXXL
Weight	White 48gsm Navy 50gsm Red 50gsm Orange 50gsm

ANSELL-1500-WH PLUS CVRL HOOD 111
SIZE: M, L, XL, XXL, XXL

AlphaTec®
 ADVANCED CHEMICAL PROTECTION

1500 PLUS - Model 111

Breathable, anti-static SMS material,
 Type 5/6 protection

Previously known as: MICROCHEM® by AlphaTec 1500 PLUS - Model 111

Comfortable protection from hazardous particulates in critical environments.

- Proven protection, filters 99.9% of particles >3 microns*
 - Air and water vapour permeable (breathable) fabric helps reduce the risk of heat stress
 - Optimised body fit, improving wearer comfort and safety
 - Silicone free, critical in spray painting applications
 - Anti-static, tested according to EN 1149-5
- * KAKEN Particle penetration test

Industries

- Machinery and Equipment
- Life Sciences
- Metal fabrication
- Construction
- Chemical

Applications

- Unpacking of bulk goods
- Loading and unloading of process equipment
- Body Surface checking, marking and touching up
- Assembly & inspection of components
- Painting or cleaning tools or robots
- Production line support & maintenance



EN ISO 13688:2013



PRODUCT INFORMATION

Product Material	SMS fabric with anti-static treatment
Design Features	Coverall with 3-piece hood, 2-way front zipper with re-sealable storm flap and finger loops. Elasticated hood, wrists, waist and ankles. Red stitching for ease of identification.
Seam Type	Stitched seams
Standards Overview	CE CATEGORY III (Type 5, Type 6, EN 1073-2, EN 1149-5)
Product Reference	1500 PLUS - Model 111
Sizes	M, L, XL, XXL, XXXL
Weight	White 48gsm Light Blue 60gsm Navy 50gsm

CODE

ANSELL-1800-WH CVRL HOOD 111
SIZE: M, L, XL, XXL, XXL

AlphaTec®
ADVANCED CHEMICAL PROTECTION

1800 STANDARD - Model 111

Lightweight, breathable microporous laminate technology, Type 5/6 protection

Previously known as: MICROCHEM® by AlphaTec 1800 STANDARD - Model 111

Good protection from low hazard liquid spray and fine particulates with bound seams for improved overall protection

- Protects against low hazard liquid spray and fine particulates
- Comfortable to wear featuring moisture vapour permeable fabric ("breathable") to help reduce the risk of heat stress
- Optimized body fit, improving wearer comfort and safety
- Anti-static, tested according to EN 1149-5 and AATCC 76
- Low linting to help reduce the risk of cross contamination in critical areas
- Silicone free, critical in spray painting applications

Industries

- Life Sciences
- Automotive
- Metal fabrication
- Food Processing
- Chemical
- Automotive Aftermarket
- Mining

Applications

- Clean room cleaning and preparing
- Body painting including surface inspection
- Production line support & maintenance
- Cleaning of plant and machines
- Maintenance of plant and machines
- Fibre Glass Resin Applications
- Handling of powders



EN ISO 13688:2013



PRODUCT INFORMATION

Product Material	Microporous polyethylene laminate non-woven
Design Features	Coverall, 3-piece hood, 2-way front zipper with re-sealable storm flap. Elasticated hood, waist, wrists and ankles.
Seam Type	Bound Seams
Standards Overview	CE CATEGORY III (Type 5, Type 6, EN 1149-5)
Product Reference	1800 STANDARD - Model 111
Sizes	M, L, XL, XXL, XXXL
Weight	53gsm

ANSELL-2300-YY PLUS CVRL HOOD 132
SIZE: M, L, XL, XL, XXL

AlphaTec®
 ADVANCED CHEMICAL PROTECTION

2300 PLUS - Model 132

Medium duty chemical barrier, Type 3/4/5 protection

Previously known as: MICROCHEM® by AlphaTec 2300 PLUS - Model 132

Lightweight and durable chemical protection against a range of inorganic chemicals and biological hazards.

- A good protective barrier to numerous inorganic liquid chemicals including acids and bases
- Type 3 coverall, lightweight, yet relatively strong and durable
- Designed to protect, typical coverall features include respirator fit hood and a zip flap with self-adhesive tape closure
- Highly visible bright yellow for improved worker safety
- Anti-static, tested according to EN 1149-5



Industries

- Life Sciences
- Machinery and Equipment
- Agriculture
- Food Processing

Applications

- Environmental clean-up and remediation
- Tank Cleaning
- Equipment maintenance and repair



TYPE 3-B



TYPE 4-B



TYPE 5-B



0598



EN 1073-2



EN 1149-5

EN ISO 13688:2013



EN 14126

PRODUCT INFORMATION

Product Material	Polyethylene on bicomponent Polypropylene /Polyethylenenon-woven
Design Features	Coverall, 3-piece hood, 2 way front zipper with re-sealable storm flap, finger loops. Elasticated hood, waist, wrists and ankles.
Seam Type	Stitched and Taped
Standards Overview	CE CATEGORY III (Type 3-B, Type 4-B, Type 5-B, EN 1073-2, EN 14126, EN 1149-5)
Product Reference	2300 PLUS - Model 132
Sizes	M, L, XL, XXL, XXXL
Weight	65gsm

GLOBAL SALES AND SUPPLY CHAIN INFRASTRUCTURE

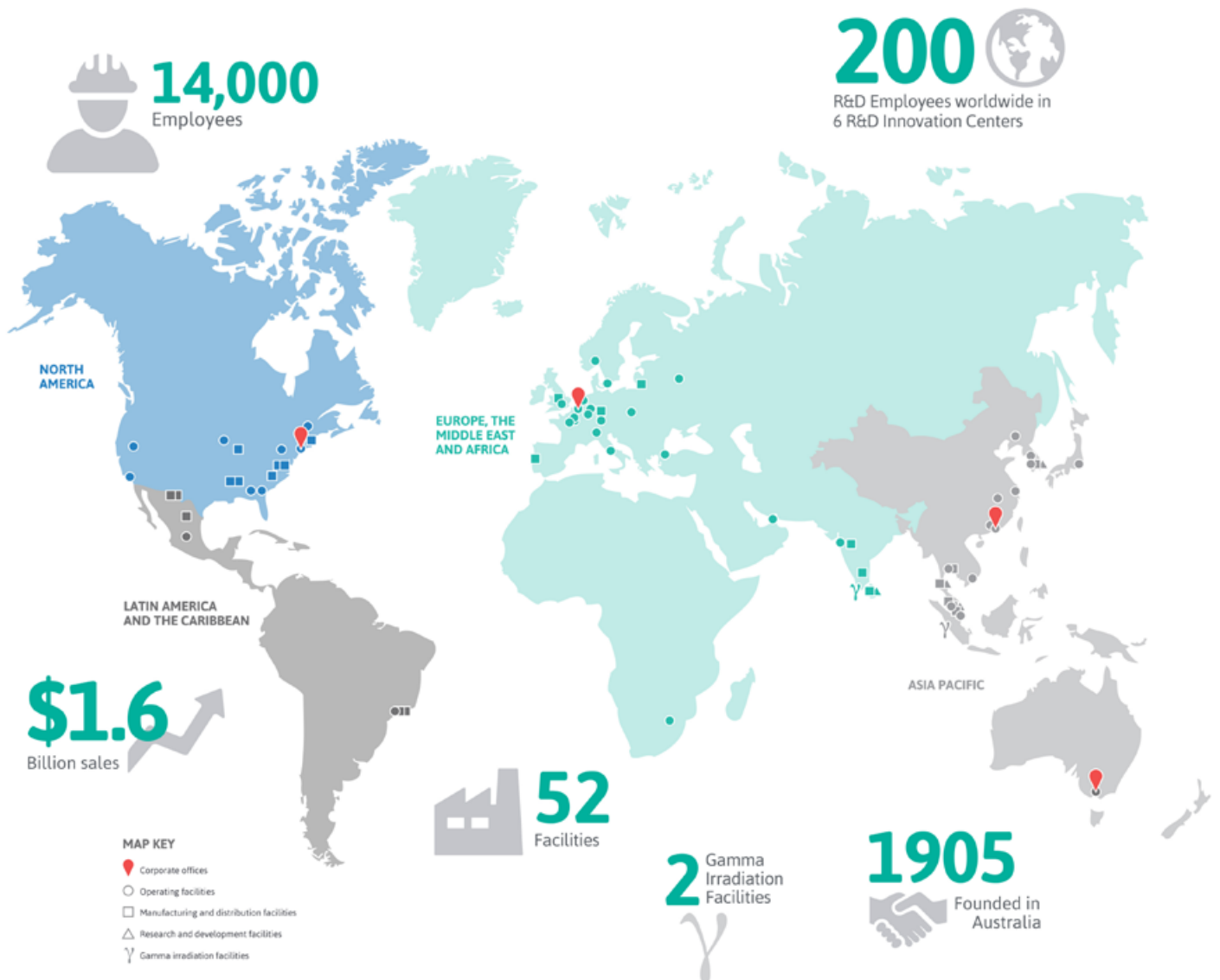

ANSELL LIFE SCIENCES

Ansell has been providing protection solutions for over 100 years and offers a comprehensive range of personal and product protection solutions to meet the needs of the life sciences industry. There are four main categories of companies we service, each with their own unique needs and challenges, which Ansell addresses with a full range of portfolio solutions:

1. Pharmaceutical industry
2. Biotechnology industry

3. Medical device industry
4. Research laboratories



Andreas Jacovides Trading Ltd

☎ +357 22 866300 | Fax: +357 22 454843

@ sales@ajacovides.com

📍 9 Imvrou, Industrial Area of Latsia | 2234 Nicosia, Cyprus | P.O.Box 17047, 2260 Latsia | Nicosia, Cyprus

f A. Jacovides Trading Ltd 📷 ajacovidestrading in Andreas Jacovides Trading Ltd

2025

