

# Aluminium Sign Systems

**ajacovides**  
Andreas Jacovides Trading Ltd



2022



Global  
Engineering



## BUSINESS PROFILE

**Andreas Jacovides Trading Ltd** is praised as a pioneering force in delivering leading performance solutions and products enhanced by high-quality standards and environmental awareness.

Our company was founded in 1982 and became a Leader in the supply and distribution of innovative products in the Cyprus Market.

We invest heavily in building excellent customer service and support through our highly skilled engineers and staff. Emphasis is given in creating outstanding relationship with our clients and suppliers and we constantly focus on our partner's business needs. Based on our experience and in-depth technical knowledge we have achieved recognition as a trustworthy and reliable partner on whom our clients and associates can rely.

The company has its head offices in Latsia Industrial Area at the outskirts of Nicosia. This allows easy access all over Cyprus with fast and express delivery.

## WHAT WE DO

We are importers of a wide range of industrial products.  
The major groups of products we offer are:

- ▶ Aluminium Composite Panels
- ▶ Polycarbonate & Polyester Sheets
- ▶ Pvc & Acrylic Sheets
- ▶ Decorative Films
- ▶ Solar Films
- ▶ Safety & Security Films
- ▶ Graphic and Digital Printing
- ▶ Powder Coating
- ▶ LED & Power Supplies

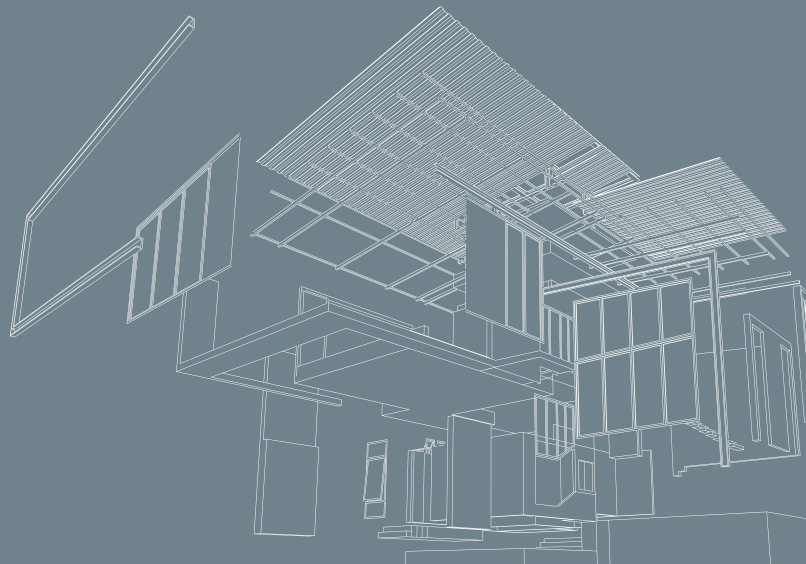

**Commercial Graphics & HP Large format printers**

**ajacovides**  
experience innovation reliability

Printable, Decorative, Reflective, Solar, Safety Films | Large Format Printers | Signage CNC Routers  
Acrylic, Pvc, Foam Sheets | Signage systems

**Architectural & Interior Design**

**ajacovides**  
experience innovation reliability

Building Materials • Aluminium Composite panels • Pvc Composite Sheets  
• Acrylic Sheets • Multi & Solid Polycarbonate Sheets

**Powder Coatings**

**ajacovides**  
experience innovation reliability

Powder Coating for all metallic creations • Windows & doors • Facades, curtain walling & metal shells  
• Sunshades & shutters • Fencing, railings & handrails • Ceiling tiles • Garage doors  
• Verandas, winter gardens, greenhouses & conservatories

**Sun Control Films  
Safety & Security Films**

**ajacovides**  
experience innovation reliability

**3M**  
Authorized Distributor  
Industrial Products

**Personal Safety Equipment**

**ajacovides**  
experience innovation reliability

Προστασία εναντίον, ακαθαρσίας, όξινος, βασικής, κεφαλικής  
Μόσκεις προοιούμ για όλους τους επαγγελματίες  
Ζώνες προστασίας | Φωσφορίζοντα γαλκία, σταλές | Μόσκεις συγκολλητών

**3M**  
Authorized Distributor  
Industrial Products

**Display Stands**

**ajacovides**  
experience innovation reliability

Roll-up • X-banner • Pop up Magnetic Spider • Promotion Table • Wall snap frame  
A board snap frame • Brochure holder • Teardrop & Feather Flag

**Aluminium Sign Systems**

**ajacovides**  
experience innovation reliability

Textile Aluminium frames Indoor • Wall Banner frames • Acrylic outdoor frames • Info System  
Bannerbox outdoor • Clip frames • Pylon outdoor signs • Readymade Panel & Magnetic Led Frames

**Led Lighting & Power Supply**

**ajacovides**  
experience innovation reliability

Led strips | Led modules | Power supply | Transformers | KNX | Illuminated Led sign Systems  
Neon Flex

**Traffic Safety & Signage**

**ajacovides**  
experience innovation reliability

Traffic Signs | Street name signs | Cones | Bollards | Barriers | Speed Reducer  
Road Studs | Solar Warning Lamps | Mirrors | Solar Cat Eyes | Directional Led Panel  
Led Traffic Light | Warning Trailer | Pedestrian Safe System | Road Marking Paints

**Glass Machinery & Applications**

**ajacovides**  
experience innovation reliability

Glazing Machinery | Tables for floating and laminated glass cutting | Φορτωσι Laminated / tempered  
Aluminium spacers for glass

**Chemicals & Activated carbon**

**ajacovides**  
experience innovation reliability

Wide range of industry-leading activated carbon solutions, serving the transportation, infrastructure,  
pharmaceutical and environmental industry in Cyprus.

**Medical Procurement**

**ajacovides**  
experience innovation reliability

Laryngectomy care products  
Atos Medical product series refer to a broad product range of voice and pulmonary rehabilitation  
devices consisted in voice prosthesis, HME and speaking valves, adhesives and supplemental  
accessories for Stoma covers.





## ALUMINIUM SIGN SYSTEMS



# SYMBOLS



Single-sided



Double-sided



Indoor



Outdoor



Light system



Non-light system



Cutting at a 45 degree angle



Cutting at a 90 degree angle



Fittings included



Qualanod standart



Textile



PVC Banner



PMMA



Snap system



Magnetic system



Frequent poster replacement



Lock system



Year warranty



Top quality alloy  
6060, 6063

### TexFrame 16

Profile System for making of single-sided non-light frame with textile tensioning up to 1000 microns thick.

Frame Depth is 16 mm. Used for making of Small-Size Frames.

Textiles are mounted in Frame using PVC Strips or PVC Cord. PVC Strip is sewn (glued) according to the Scheme on the Textile reverse side. PVC Cord is pulled into the Groove with

Special Roller from the Textile front side. Special Docking Plate is used to build the Profile lengthwise.



### System Components

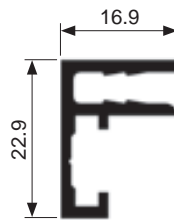

#### TF BA016/1SM

Profile Basic Textile 16 mm one-sided, anode, matt silver, 6.1 m, 1.85 kg

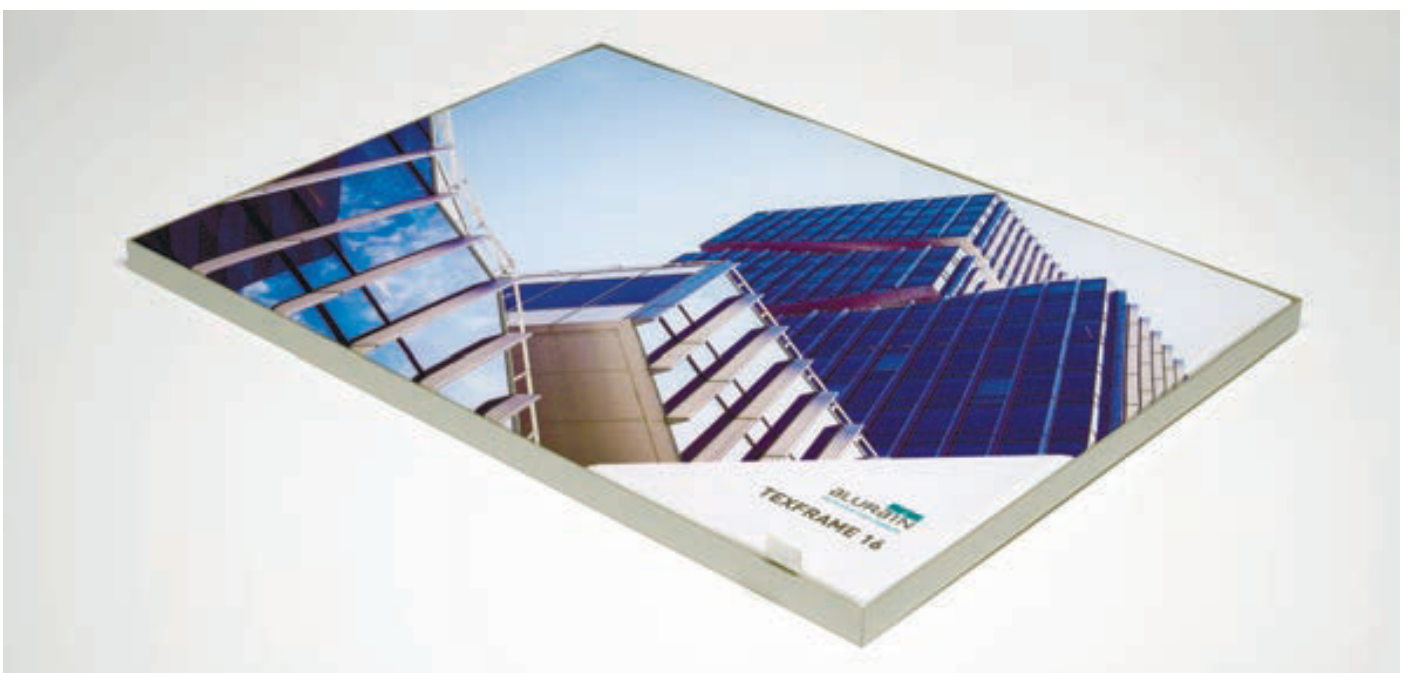





## Specification of components for one frame:

Profile	Quantity of components			
	AC FC013A	C AP011	AC LP038	AC CD005 or AC TP015
TF BA016/1SM4		no	no	perimeter
TF BA022/1SM8		4m	in 2	perimeter
TF BA045/2SM8		4n	o	perimeter x2

### TexFrame 22 NEW

Profile System for making of single-sided non-light frame with textile tensioning up to 1000 microns thick.

Frame Depth is 22 mm. Used for making of Large-Size Frames.

Profile Inpost is used to strengthen the structure inside the Frame.

Textiles are mounted in Frame using PVC Strips or PVC Cord. PVC Strip is sewn (glued) according to the Scheme on the Textile reverse side. PVC Cord is pulled into the Groove with Special Roller from the Textile front side. Special Docking Plate is used to build the Profile lengthwise.



#### System Components



€20.00/R.m.

#### TF BA022NEW/1SM

Profile Basic Textile 22 mm one-sided NEW, anode, matt silver 6.1 m, 3.95 kg

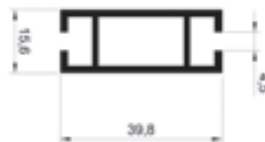

€20.00/R.m.

#### PR TU416

Profile Inpost 40x16 mm, Alu, unpainted 6.1 m, 3.4 kg







## Specification of components for one frame

Profil	Quantity of components			
	AC FC013	AC AP011	AC LP038	AC CD005 or AC TP015
TF BA016/1SM	4n	on	o	perimeter
TF BA022/1SM	84		min 2	perimeter
TF BA045/2SM	84		no	perimeter x2



€2.00/pcs



€2.00/pcs



€2.00/pcs



### TexFrame 45 NEW

Profile System for making of double-sided non-light frame with textile tensioning up to 1000 microns thick.

Frame Depth is 45 mm. Used for making of Small-Size Frames and Interzonal Partitions.

Profile Inpost is used to strengthen the structure inside the Frame.

Textiles are mounted in Frame using PVC Strips or PVC Cord. PVC Strip is sewn (glued) according to the Scheme on the Textile reverse side. PVC Cord is pulled into the Groove with Special Roller from the Textile front side.

Special Docking Plates are used to build the Profile lengthwise. Base is used to mount the Frame on the Floor.



#### System Components

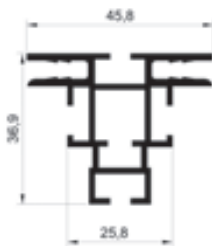

##### TF BA045NEW/2SM

Profile Basic Textile 45 mm two-sided NEW, anode, matt silver 6.1 m, 5.47 kg

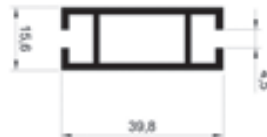

##### PR TU416

Profile Inpost 40x16 mm, Alu, unpainted 6.1 m, 3.4 kg







## Specification of components for one frame

Profil	Quantity of components			
	AC FC013	AC AP011	AC LP038	AC CD005 or AC TP015
TF BA016/1SM4		no	no	perimeter
TF BA022/1SM8		4m	in 2	perimeter
TF BA045/2SM8		4n	o	perimeter x2



### ClicFrame 33

Profile System for making of One-Sided Non-Exposed Click Frame for frequent and rapid change of information.

Covering Profile 33 mm

wide can be of 2 types:

1. Rounded (SL) cross-section.
2. Square (SQ) cross-section.

Insert Thickness from 3 to 6 mm.

Click Frame is assembled in two ways:

1. Inner angles, Profile is cut at 45°.
2. Outer decorative angles, Profile is cut at 90°.

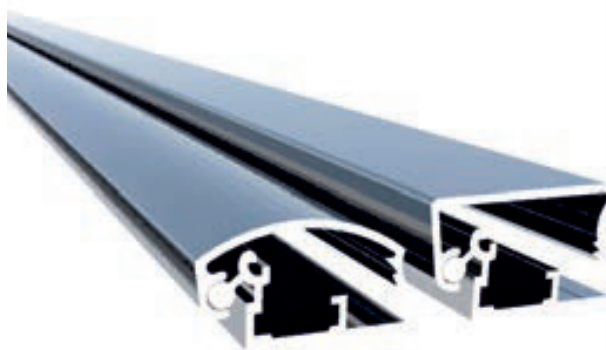

### System Components



#### CF SL033/1SM

Profile Cover Click 33 mm SL  
anode, matt silver, 6.1 m, 1.13 kg



#### CF SQ033/1SM

Profile Cover Click 33 mm SQ  
anode, matt silver, 6.1 m, 1.38 kg

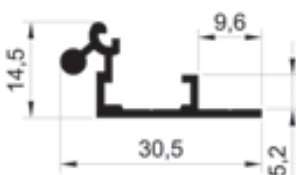

#### CF BA033/1MF

Profile Basic Click 33 mm,  
unpainted 6.1 m, 1.36 kg





## Specification of components for one frame

Profil	Quantity of components	
	AC FC013 or AC CP033/SL/SQ	AC FS027
CF SL033/1SM or CF SQ033/1MF + CF BA033/1MF	4	3-4 per meter, min 8 pcs

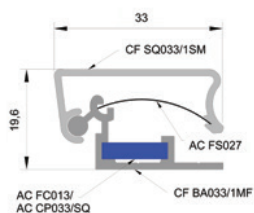
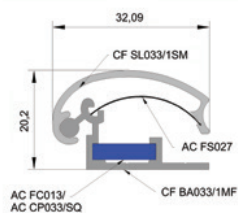

**AC FC013**  
Click Angle 33 mm  
(13 mm) Inner Screw  
Steel (TF, BF No.5)



**AC CP033/SL**  
Click Angle 33 mm  
(13 mm) Inner Screw  
Steel (TF, BF No.5)



**AC CP033/SQ**  
decorative corner  
connector  
click 33 mm SQ,  
gray, 0,04 kg



**AC FS027**  
Spring Click 33 mm  
(22x27 mm) Steel



**AC PL100**  
Textile Plate  
100x12mm Inner  
Screw Steel  
(BF No.5, CF33)

### AcriLight Elips

Profile Systems of Rounded (Elips) Cross-Section for making of Chased Nameplates

Milling or Laser Engraving is applied on 8 mm

Transparent Acrylic. Acrylic is secured in the Profile with Pins. Pins are not included in the System Standard Furniture.

Nameplate can be hung from the Ceiling to the Hinges or mounted on the Wall by two ways, namely close to the Wall on Angular Brackets or perpendicular to the Wall on Special Round Bracket ("flag" fastening type).

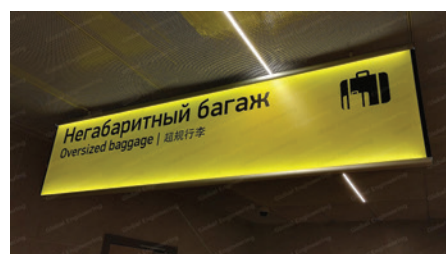
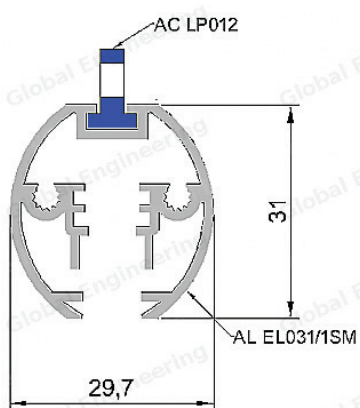
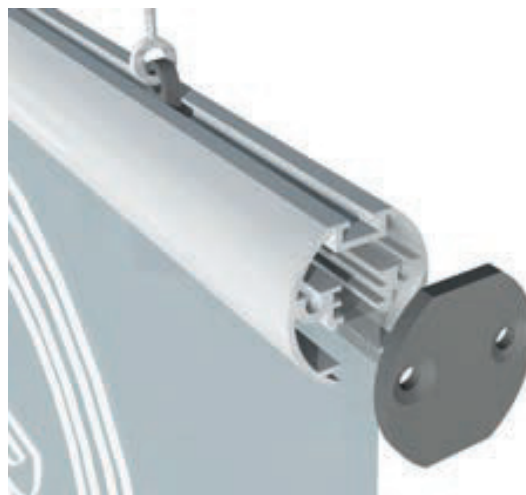

### System Components

#### AL EL031/1SM

Profile Basic AcrilLight EL,  
anode, matt silver,  
6.1 m, 3.61 kg

### Specification of components for one frame

Profil	Quantity of components				
	AC CP031	AC CP030	AC LP012	AC BR021	AC BR060
AL EL031 / 1SM	2n	on	o	Φmin 2 pcs	no
	2	no	min 2 pcsn	on	o
	1	no	no	no	1



ALLOY  
6060  
6063

↓  
15 MKM  
Qualanod



1  
WARRANTY

**aluraIN**

## Profile Systems for making of Light Boxes



# AR Box



### TexBox 66

Profile for making of Two-Sided Light Box with tensioned Textile (to 1000 microns thick).

Box Depth 66 mm

Profile Inpost is used to strengthen the structure inside the Box.

Recommended mounting interval for INPOSTs is 1.5 m.

When the Box Sides are less than 2 m, Inposts are not required.

Box is illuminated all-around with Lense-Type LED Strip. It may mounted at 40 mm wide Special Groove 40 mm in the Profile Center.

Base is used to mount the Box on the Floor.

Special Docking Plate is used to build the Profile lengthwise.

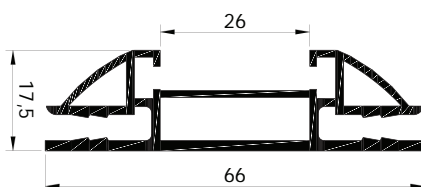

#### TB BA066/2SM

Profile Basic Box Textile  
50 mm one-sided,  
anode, matt silver,  
6.1 m, 6.9 kg

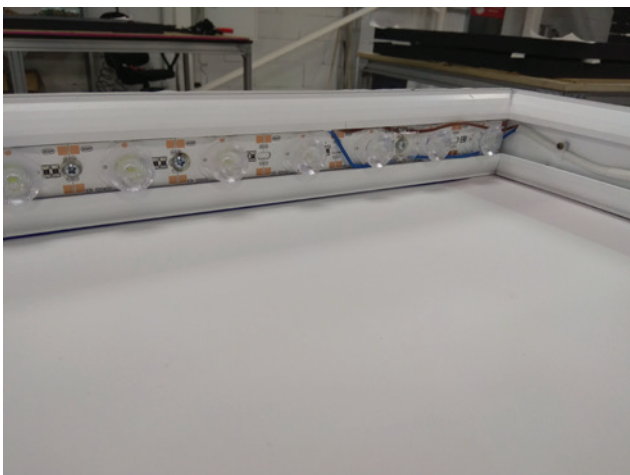



## Specification of components for one frame

Profil	Quantity of components		
	AC FC006	AC AP025	AC CD005 or AC TP015
TB BA100 / 2SM	84		perimeter X2



### AC FC006

Click Angle 25 mm  
(6 mm) Inner Screw  
Steel

### AC AP025



corner connector 25 mm alum (TB 66)

### TexBox 70

Profile System for making of One-Sided Light Box with tensioned Textile to 1000 microns thick. Profile has enhanced stiffness.

Box Depth 70 mm

Sheet Material or Textile can be used as the rear wall.

Profile Inpost is used to strengthen the structure inside the Box.

Box is illuminated all-around with LED Tape or on the rear wall with LED Modules or Tapes.

Base is used to mount the Box on the Floor.

Special Profile Bracket is used to mount one-sided Box (with rigid wall) to the Wall.



### System Components

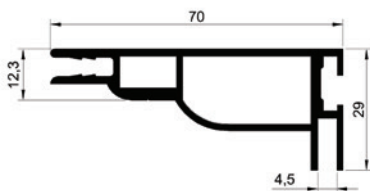

#### TB BA070/1SM

Profile Basic Box  
Textile 70 mm one-sided, anode, matt silver,  
6.1 m, 6.59 kg

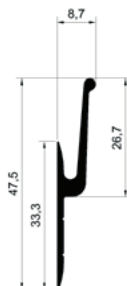

#### BF M0048/1MF

Profile Bracket for Box  
Suspension, unpainted  
6.1 m, 1.8 kg

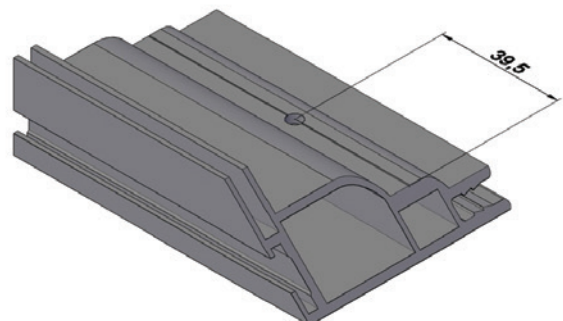





## Specification of components for one frame

Profil	Quantity of components			
	AC FC013	AC AP013	AC SC605	AC CD005 or AC TP015
TB BA070/1SM4		48		perimeter (advertising medium) + perimeter (diffusor)

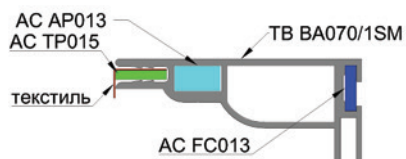

**AC FC013**  
Click Angle 33 mm  
(13 mm) Inner Screw  
Steel (TF, BF No.5)



**AC AP013**  
Angle Panel (13 mm)  
Alu



**AC SC605**  
Screw 6x5mm Steel

### TexBox 100 Armed

Profile System for making of One-Sided (optionally Two-Sided) Light Box with tensioned Textile to 1000 microns thick. Profile has enhanced stiffness.

Box Depth 100 mm

Sheet Material or Textile can be used as the rear wall.

Profile Inpost is used to strengthen the structure inside the Box.

Box is illuminated all-around with LED Tape or on the rear wall with LED Modules or Tapes.

Base is used to mount the Box on the Floor.

Special Profile Bracket is used to mount one-sided Box (with rigid wall) to the Wall.

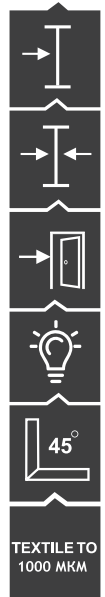

### System Components

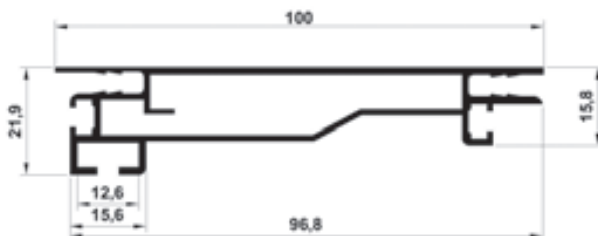

#### TB BA100/2SM

Profile Basic Box Textile  
100 mm two-sided,  
anode, matt silver,  
6.1 m, 6.59 kg

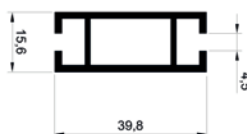

#### PR TU416

Profile Inpost 40x16 mm,  
Alu, unpainted  
6.1 m, 3.4 kg



#### BF M0048/1MF

Profile Bracket for Box  
Suspension, unpainted  
6.1 m, 1.8 kg



**HENDERSON**

25 ЛЕТ СТИЛЯ



HENDERSON.RU

## Specification of components for one frame

Profil	Quantity of components		
	AC FC006	AC AP031	AC CD005 or AC TP015
TB BA100 / 2SM	88		perimeter

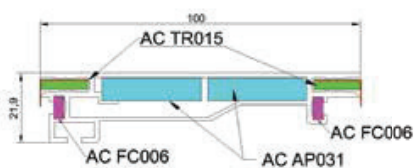

**AC FC006**  
Click Angle 25 mm  
(6 mm) Inner Screw  
Steel



**AC AP031**  
Connecting Angle  
31 mm Alu (CB  
50/100, TB, BB)



### TexBox 180

Profile for making of Two-Sided Light Box with tensioned Textile (to 1000 microns thick).

Box Depth 180 mm

Profile Inpost is used to strengthen the structure inside the Box.

Recommended mounting interval for INPOSTs is 1.5 m.

When the Box Sides are less than 2 m, Inposts are not required.

Box is illuminated all-around with Lense-Type LED Strip. It may mounted at 40 mm wide Special Groove 40 mm in the Profile Center.

Base is used to mount the Box on the Floor.

Special Docking Plate is used to build the Profile lengthwise.

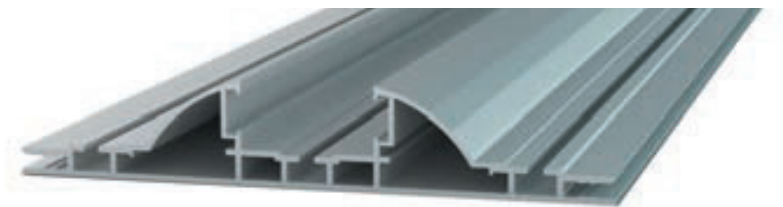

### System Components

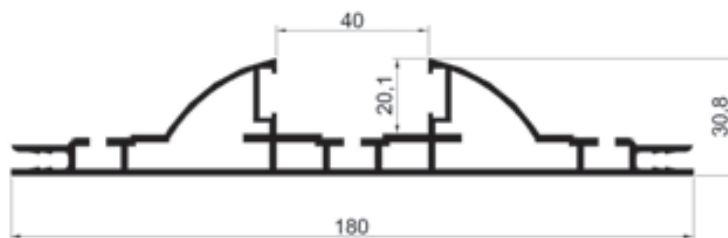

#### TB BA180/2SM

Profile Basic Box Textile  
180 mm two-sided,  
anode, matt silver,  
6.1 m, 15.85 kg

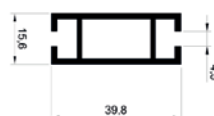
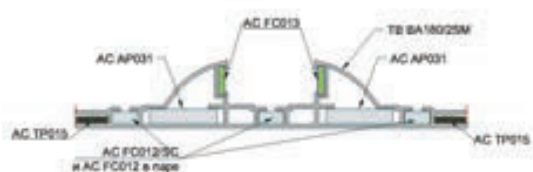

#### PR TU416

Profile Inpost 40x16 mm,  
Alu, unpainted  
6.1 m, 3.4 kg



## Specification of components for one frame

Profil	Quantity of components				
	AC FC013	AC FC012	AC FC012/SC	AC AP031	AC CD005 or AC TP015
TB BA180 / 2SM	81	21	28		perimeter x2



**AC FC013**  
Click Angle 33 mm  
(13 mm) Inner Screw  
Steel (TF, BF No.5)



**AC FC012**  
Angle Inpost 12 mm  
Steel without Screws,  
0.018 kg



**AC FC012/SC**  
Angle Inpost 12 mm  
Steel with Screws,  
0.019 kg



**AC AP031**  
Connecting Angle  
31 mm Alu (CB  
50/100, TB, BB)

### BannerBox 110

Profile System for making of One-Sided Light Box with tensioned Banner

Box Depth 110 mm

The system enables to make very large -size Advertising Structures, not limited to the Acrylic glass size.

Simple and reliable Banner mounting enables quick change Canvas without additional Firmware or Banner welding.

Pipe 40x20 mm is used as Stiffening Ribs inside the Box.

Box is illuminated on the rear wall with LED Modules.



### System Components

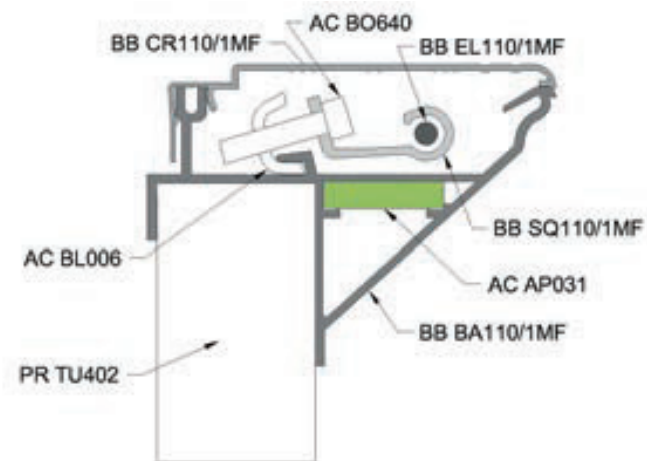

#### BB CR110/1MF

Profile Cover Box Banner 110 mm, unpainted 6.1 m, 3.36 kg

#### BB BA110/1MF

Profile Basic Box Banner 110 mm, unpainted 6.1 m, 10.35 kg

#### BB SQ110/1MF

Profile Tensioning Box Banner, unpainted 6.1 m, 0.8 kg

#### BB EL110/1MF

Profile Clamping Box Banner, unpainted 2 m, 0.16 kg

#### PR TU402

Profile Pipe 40x20x2 mm, Alu, unpainted, 6.17, 6.0 m, 3.64 kg

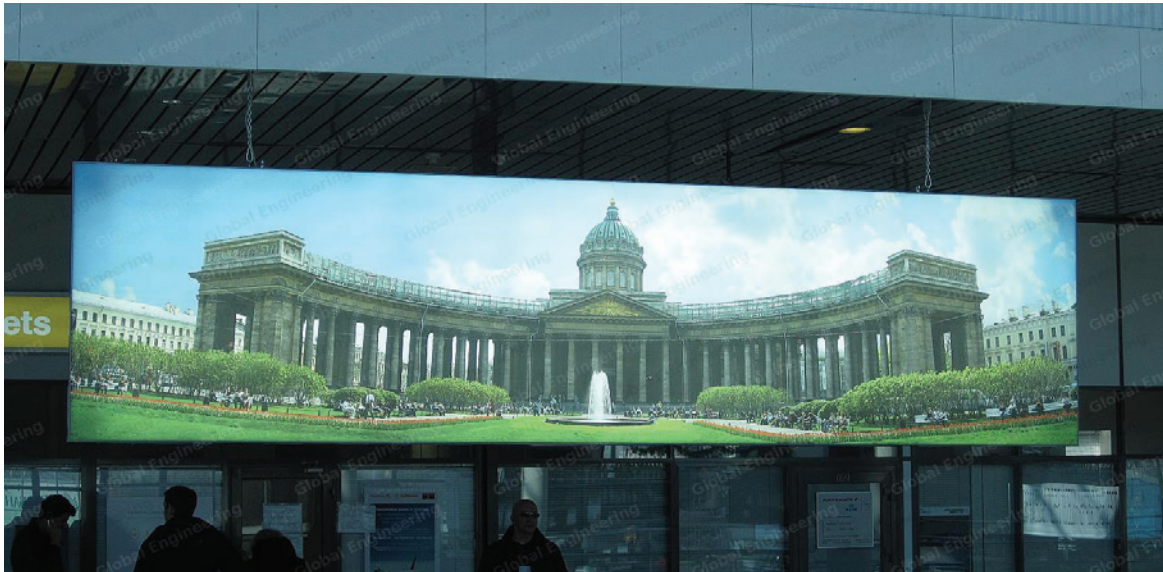

Cutting pattern of PVC banner for BannerBox 110, 200 mm systems

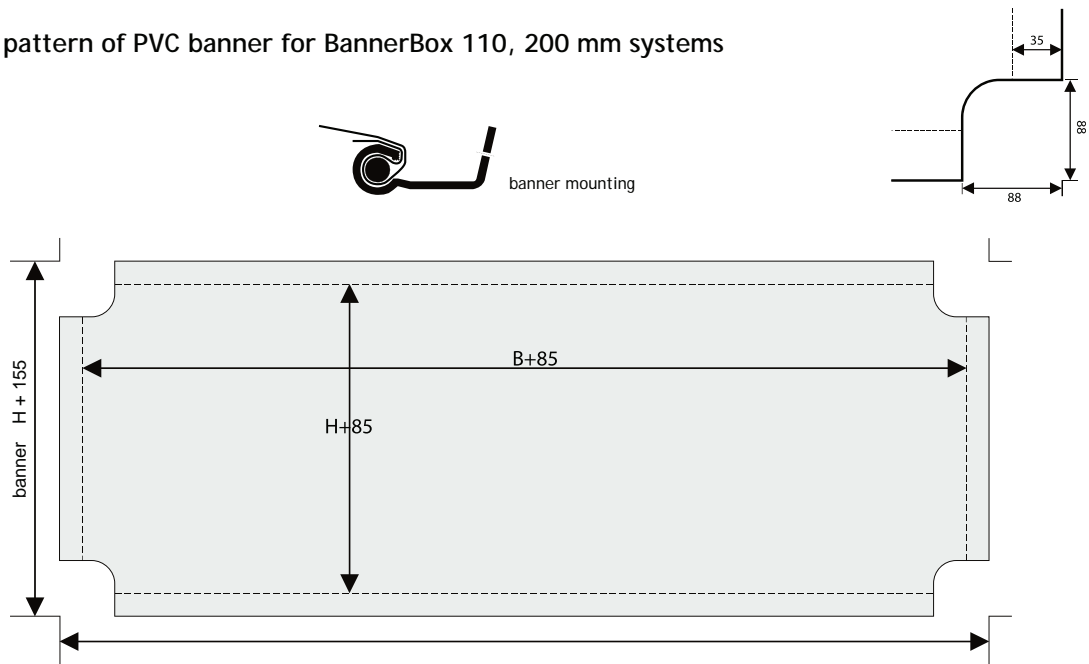

Profile System for making of One-Sided Light Box with tensioned Banner

Box Depth 110 mm

The system enables to make very large -size Advertising Structures, not limited to the Acrylic glass size.



Simple and reliable Banner mounting enables quick change Canvas without additional Firmware or Banner welding.

Pipe 40x20 mm is used as Stiffening Ribs inside the Box. Box is illuminated on the rear wall with LED Modules.

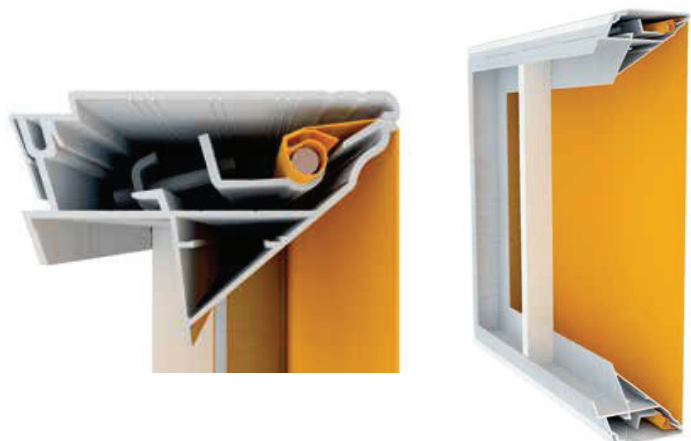





## Specification of components for one frame

### Fitting:



**AC BL006**  
Unit Steel (BB)



**AC BO635(40)**  
Bolt M6 Steel (BB)



**AC AP031**  
Connecting Angle  
31 mm Alu (CB  
50/100, TB, BB)

### Specification of components for one frame

Profile	Quantity of components		
	AC BL006	AC BO635(40)	AC AP031
BB BA110 / 1MF + BB CR110 / 1MF	no	no	4
BB SQ110 / 1MF + BB EL110 / 1MF	7 on whip (2m)	7 on whip (2m)	no

### BannerWall

Profile System is used for making of Non-Exposed Frame with tensioned Banner on flat surfaces.

Used in advertising for making of Large Non-Illuminated Structures to be mounted on Buildings or Advertising Boards. And also, in the transport sector for quick-change advertising on the Board Sides of Trucks, Vans and Trailers.

The Frame upper part is made of the Holder Profile, the other three sides of the Tensioner Profile, Stop and Retainer each. Frame Angles are covered with ABS Plastic Pads.

Ad uses Cast Banner with Cedar or lightweight Banner with Cord. For transport is used only Cast Banner with density not more than 500 g/m2 with Cedar.



### System Components

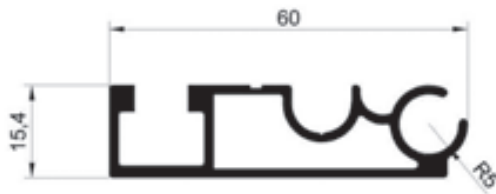

#### BW H0060/1SM

Profile Holder Banner 60 mm,  
anode, matt silver, 6.1 m, 4.04 kg



#### BW TE083/1SM

Profile Tensioner Banner 83 mm,  
anode, matt silver, 6.1 m, 4.26 kg

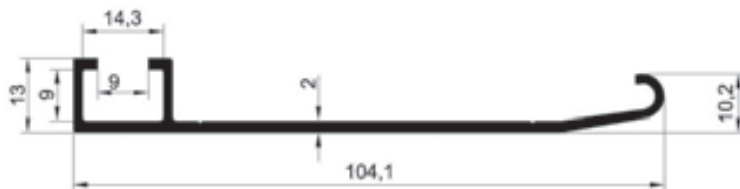

#### BW PA104/1SM

Profile Rest Banner 104 mm,  
anode, matt silver, 6.1 m, 4.29 kg

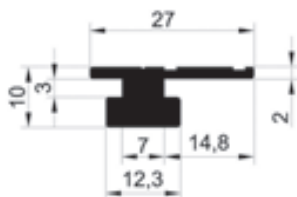

#### BW CL027/1SM

Profile Retainer Banner 27 mm,  
anode, matt silver, 6.1 m, 2.21 kg



## Specification of components for one frame

Profile	Quantity of components				
	AC CR100/G or AC CR200/G	AC BO815	AC NU008	AC WA008	AC KD008/2 or AC CD008
BW HO060/1SM	48		88		perimeter
BW TE083/1SM + BW PA104/1SM + BW CL027/1SM	48		88		perimeter



**AC CR100/G**  
Angular Pad ABS,  
grey, 0.08 kg



**AC BO815**  
Bolt 8x15 mm



**AC NU008**  
Cap Screw M8



**AC WA008**  
Toothed Washer M8



**AC KD008/2**  
Two-leafed Cedar D8,  
white, 0.096 kg.



**AC CR200/G**  
Angular Pad ABS,  
grey, 0.1 kg



**AC CD008**  
PVC Cord Banner  
(8 mm), white

# AR Frame | BannerWall

## Frames with Banner

### CUTTING PATTERN OF PVC BANNER FOR BANNERALL SYSTEM

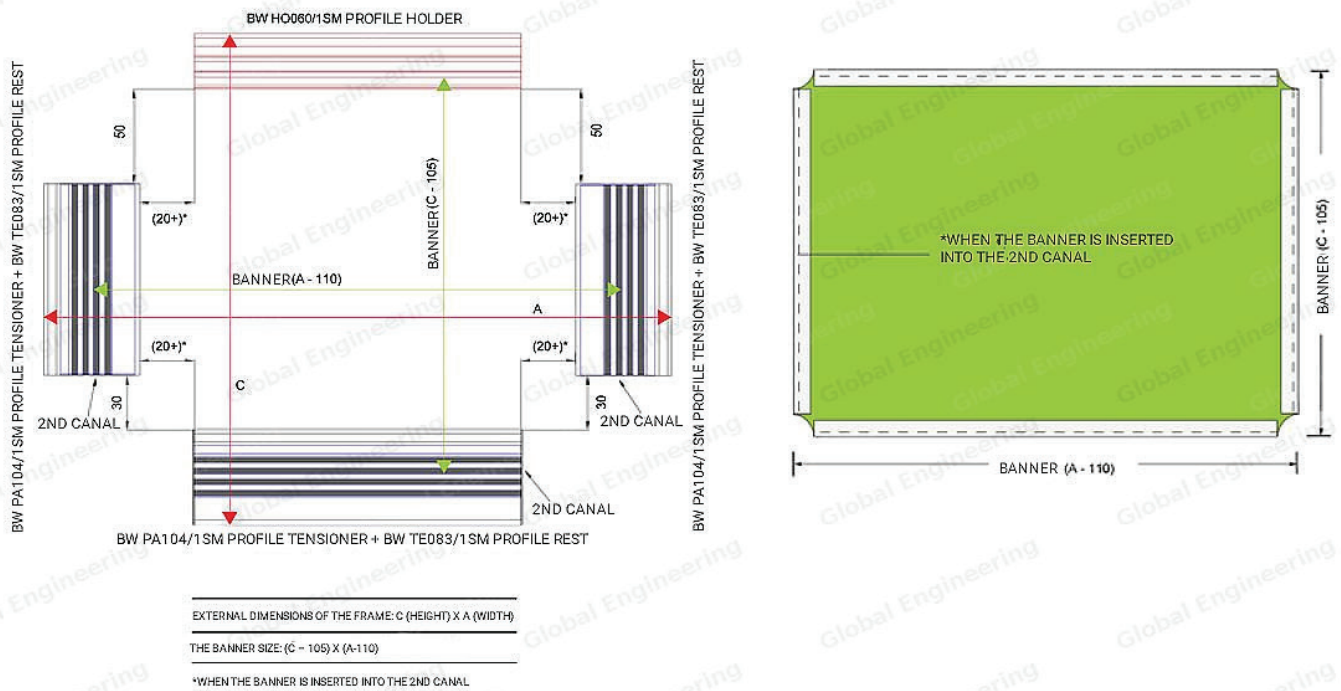





**Box with Acrylic and Split Side**

**InBox 100**  
**OutBox 150**

**Box with Acrylic and Click System**



### InBox 100

Profile System for making of One / Two-Sided Light Box with Split Side

Box Depth 100 mm

Box's three sides are made of Basic Profile, the fourth side is made of Split Profile with Covers.

Milky Acryl is used as dffuser in the Box.

Box is illuminated all-around with LED Tape. One-Sided box may be also illuminated on the rear wall with LED modules or Tapes.

Special Profile Bracket is used to mount one-sided Box to the Wall.



### System Components

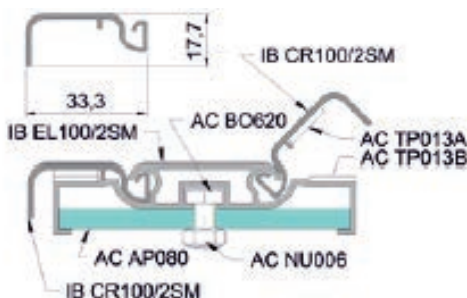
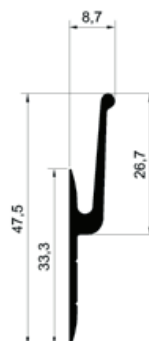
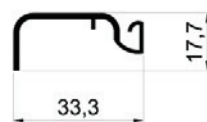
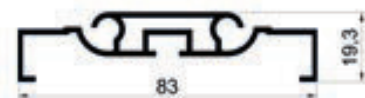
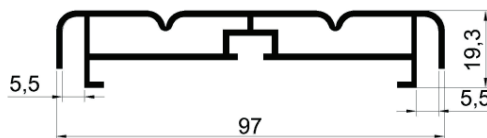

#### IB BA100/2SM

Profile Basic Box 100 mm two-sided, anode, matt silver, 6.1 m, 6.49 kg

#### IB EL100/2SM

Profile Split Box 100 mm two-sided, anode, matt silver, 6.1 m, 4.97 kg

#### IB CR100/2SM

Profile Cover Box 100 mm two-sided, anode, matt silver, 6.1 m, 1.4 kg

#### BF M0048/1MF

Profile Bracket for Box Suspension, unpainted 6.1 m, 1.8 kg



## Specification of components for one frame

Profil	Quantity of components			
	AC AP080	AC BO620	AC NU006	AC TP013A/CN + AC TP013B/CN
IB BA100 / 2SM	48		8	detachable side x2
IB EL100 / 2SM + IB CR100 / 2SM				

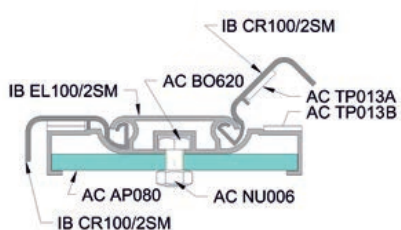

**AC AP080**  
Connecting Angle  
80 mm Alu (IB)



**AC BO620**  
Bolt 6x20 mm  
(IB, OB)



**AC NU006**  
Nut M6 (IB, OB)



**AC TP013A/CN**  
Magnetic Tape,  
type A, 0.066 kg.,  
with TESA glue



**AC TP013B/CN**  
Magnetic Tape,  
type B, 0.066 kg.,  
with TESA glue



### StandBox 80

Profile System for making of Two-Sided Stand-Alone Light Structure - Large-Size Stele.

Pipe 80x80 mm is used to connect the Stele Lateral Sides, as well as to be mounted at Outdoor Cement Base.

Base and Cover are not included in the System Standard Furniture.

#### System Components

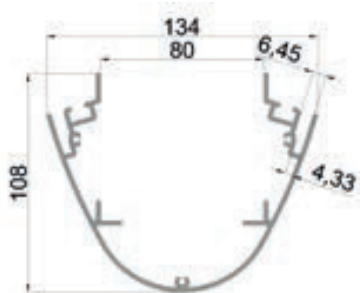

#### SB BA080/2SM

Profile Basic Pylon 80, anode, matt silver, 6.1 m, 16.57 kg



# TexBox Base

Metallic base for Tex Boxes

## AC\_BASE300

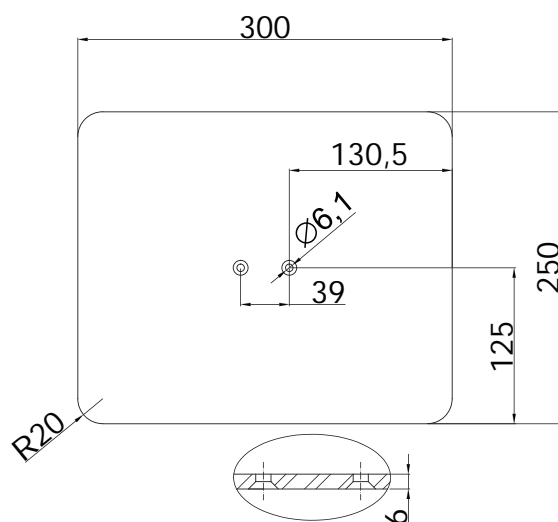

AR Box-TexBox- base for elips profile (PR RO251) 250x300 mm , 3,338 kg, grey

## AC\_BASE500

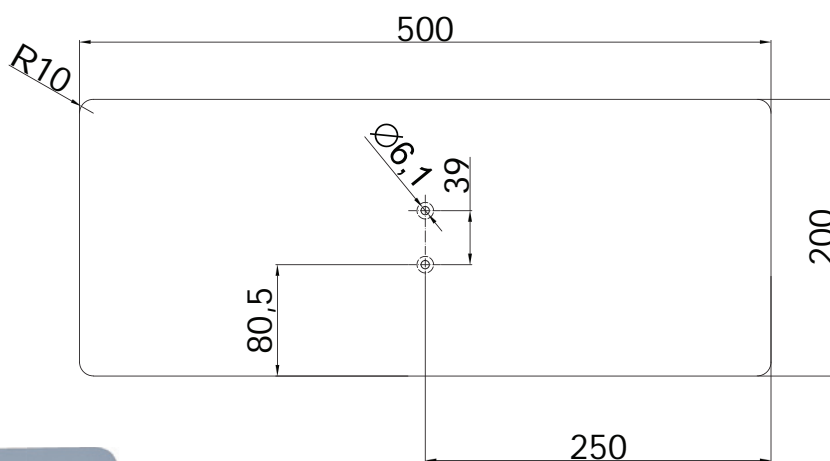

AR Box-TexBox-Base for elips profile (PR RO251), 200\*500 mm, 4,45 kg, grey

### WindowBox 30

Profile System for making of One -Sided Non-Light Box with Drop Doors

Box Depth 30 mm Box Base is made of Basic Profile. Door side that joins the base is made of Hinged Profile, the other three are made of Framed Profile.

Box can be used on the street, since it is possible to install the Rubber Seal, which makes it waterproof.

Lock is mounted on the Door to protect against opening.

Poster can be locked in the Box in two ways:

1. On the Rear Wall;
2. On the Door from the inside with Magnetic Tapes

Special Profile Bracket is used to mount Box to the Wall.



### System Components

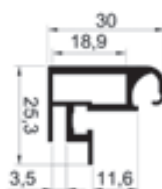

#### WB BA030/1SM

Profile Basic Shelf 30 mm, anode, matt silver, 6.1 m, 2.9 kg

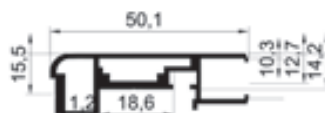

#### WB FRO50/1SM

Profile Framed Shelf 50 mm, anode, matt silver, 6.1 m, 3.56 kg

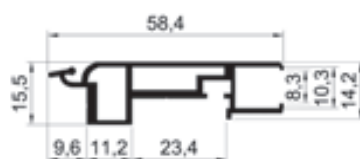

#### WB HG058/1SM

Profile Hinged Shelf 58 mm, anode, matt silver, 6.1 m, 3.7 kg

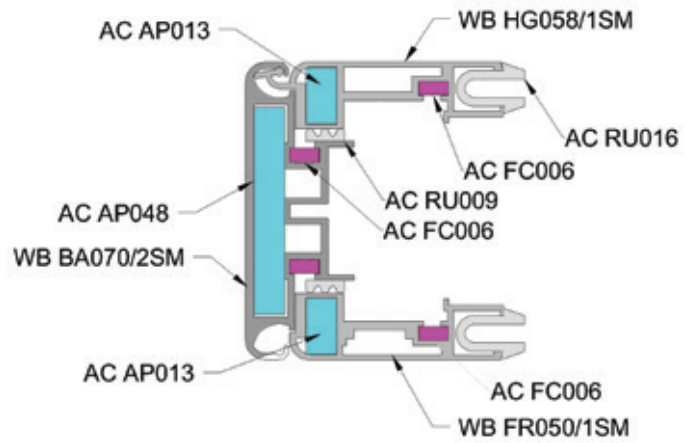

## Specification of components for one frame

Profile	Quantity of components						
	AC FC006	AC AP013	AC AP018	AC SC605	AC SC608	AC RU009	AC RU016
WB BA030 / 1SM	424			no	no	perimeter	o
WB FR050 / 1SM + WB HG058 / 1SM (furniture for 1 door)	44		no	82		no	perimeter



**AC FC006**  
Click Angle 25 mm  
(6 mm) Inner  
Screw Steel



**AC AP013**  
Connecting Angle  
13 mm Alu (WB  
30/70), 0.018 kg



**AC AP018**  
Connecting Angle  
18 mm Alu (WB 70),  
0.026 kg



**AC SC605**  
Screw 5x6 mm  
Steel (PL20)



**AC SC608**  
Support Screw  
DIN 914 6x8



**AC LO030**  
Lock + 2 Keys



**AC RU009**  
Frame Seal 9 mm,  
rubber, black



**AC RU016**  
Glass Seal 16 mm,  
PVC



**AC TP013A/CN**  
Magnetic Tape,  
type A, 0.066 kg.,  
with TESA glue



**AC TP013B/CN**  
Magnetic Tape,  
type B, 0.066 kg.,  
with TESA glue



### WindowBox 70

Profile System for making of One / Two-Sided Light Box with Drop Doors

Box Depth 70 mm Box Base is made of Basic Profile. Door side that joins the base is made of Hinged Profile, the other three are made of Framed Profile.

Box can be used on the street, since it is possible to install the Rubber Seal, which makes it waterproof.

Lock is mounted on the Door to protect against opening. Box is illuminated all-around Box Base with LED Tape.

Poster can be locked in the Box in two ways:

1. on the Rear Wall;
2. on the Door from the inside with Magnetic Tapes.

It is possible to further squeeze Poster with Milky Acrylic, which will act as diffuser in the Light Box.

Gas Lifts can be mounted Inside the Box.

Special Profile Bracket is used to mount Box to the Wall.



### System Components

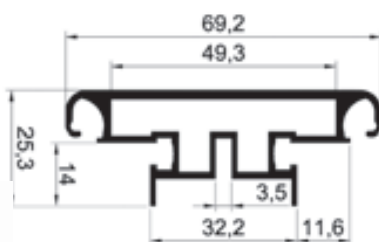

#### WB BA070/2SM

Profile Basic Shelf 70 mm two-sided, anode, matt silver, 6.1 m, 5.9 kg



#### WB FR050/1SM

Profile Framed Shelf 50 mm, anode, matt silver, 6.1 m, 3.56 kg



#### WB HG058/1SM

Profile Hinged Shelf 58 mm, anode, matt silver, 6.1 m, 3.7 kg

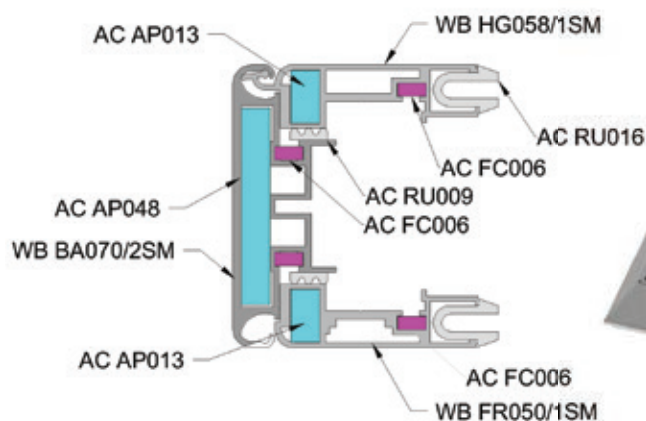

## Specification of components for one frame

Profile	Quantity of components						
	AC FC006	AC AP013	AC AP048	AC SC605	AC SC608	AC RU009	AC RU016
WB BA070 / 2SM	8n	o4		no	no	perimetern	o
WB FR050 / 1SM + WB HG058 / 1SM (furniture for 1 door)	44		no	82		no	perimeter



**AC FC006**  
Click Angle 25 mm  
(6 mm) Inner  
Screw Steel



**AC AP013**  
Connecting Angle  
13 mm Alu  
(WB 30/70),  
0.018 kg

**AC AP048**

Connecting Angle  
48 mm Alu (WB 70),  
0.068 kg



**AC SC605**  
Setting Screw DIN  
914 M6x5 Steel,  
0.0006 kg



**AC SC608**  
Support Screw  
DIN 914 6x8



**AC LO030**  
Lock + 2 Keys



**AC RU009**  
Frame Seal 9 mm,  
rubber, black



**AC RU016**  
Glass Seal 16 mm,  
PVC



**AC TP013A/CN**  
Magnetic Tape,  
type A, 0.066 kg.,  
with TESA glue



**AC TP013B/CN**  
Magnetic Tape,  
type B, 0.066 kg.,  
with TESA glue

### PanelLED 30 (EL)



Profile System for making of One / Two-Sided Light Panels with background illumination of 10 mm LED Tape.

30 mm wide Covering Profile has rounded (EL/SQ) cross-section.

Basic Profile can be of two types:

1. Profile Basic one-sided;
2. Profile Basic two-sided

#### Poster's format, mm

A0 (841\*1189)

A1 (594\*841)

A2 (420\*594)

A3 (297\*420)



### DOMINO PanelLED

Flat light snap-panels for frequent and quick change of poster.

Single/double-sided.

Covering: anodized silver matt.

# AR Panel | MagneticPanel

## Panels with Magnetic Connector and LED Illumination

### MagneticPanel 16

Profile System is used for making of 16 mm deep Two-Sided Light Panel with Front Panel Magnetic Connector.

Recommended format to A0.

As the front panel is used 1.5-2 mm thick Transparent Plastic, which is fastened to the Panel with Magnetic Tapes (type A + type B) with TESA glue.

Magnetic Tapes are closed all-around the front panel with "Rimming Strip", the recommended width is 30 mm. "Rimming Strip" can be painted or made from Vinyl Film.

To change Advertising Poster, the Front Panel is removed using Special Vacuum Cups, which ensures the anti-vandal design.

Specialized Acrylic for background illumination or Acrylic with Matrix is used for uniform glowing inside the Light Panel:

Acryl "Quinn Lumina Cast" 8 mm

Acryl with Matrix 4 mm (2 Glass with Blocking Film in the middle).



#### System Components

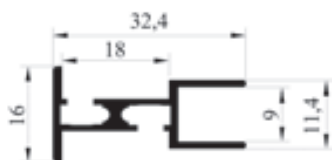

#### MP BA016/2SM

Profile Basic Panel Magnet  
16 mm two-sided, anode,  
matt silver, 6.1 m, 1.8 kg

#### Poster's format, mm

A0 (841\*1189)

A1 (594\*841)

A2 (420\*594)

A3 (297\*420)



### DOMINO Magnetic

Ultrathin flat light panels and frames  
for frequent and quick change of poster.  
To replace the poster protective plastic  
is removed with a special suction cup.

Single/double-sided.  
Covering: anodized silver matt.



# Accessories for Aluminium Profile Systems

## GLE-AC\_AP011

AR Panel-corner connector  
panel (11 mm) alum  
(PL 48/58, TF 22/45)



€12.00/pc

## GLE-AC\_AP013

AR WindowBox Corner  
connector 13 mm



€12.00/pc

## GLE-AC\_AP018

AR WindowBox Corner  
connector 18 mm



€12.00/pc

## GLE-AC\_AP025

AR Box-corner connector  
25 mm alum (TB 66)



€12.00/pc

## GLE-AC\_AP031

AR Box-corner connector  
31 mm alum (CB  
50/100,TB,BB)



€12.00/pc

## GLE-AC\_AP048

AR Box-corner connector  
48 mm



€12.00/pc

## GLE-AC\_AP062

AR Box-corner connector  
62 mm alum (TB 100)

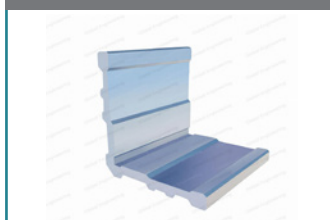

€12.00/pc

## GLE-AC\_AP080

AR Box-corner connector  
25 mm alum (TB 66)

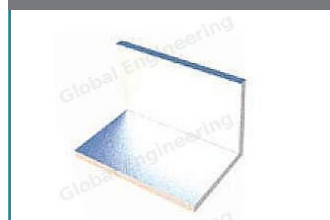

€12.00/pc

## GLE-AC\_BASE300

AR Box-Te?Box- base for  
elips profile (PR R0251)  
250x300 mm ,

**AC\_BASE300**

25x30cm



€12.00/pc

## GLE-AC\_BASE500

AR Box-Te?Box-Base for  
elips profile (PR R0251),  
200x500 mm,

**AC\_BASE500**

20x50cm



€12.00/pc

## GLE-AC\_BL006

AR Box-tension block (BB)



Unit Steel (BB)

€12.00/pc

## GLE-AC\_BO620

AR Box-bolt ?6x20mm  
(IB, OB)



**AC BO620**  
Bolt 6x20 mm  
(IB, OB)

€12.00/pc

## GLE-AC\_BO635

AR Box-bolt ?6x35mm steel  
(BB)



**AC BO635(40)**  
Bolt M6 Steel (BB)

€12.00/pc

## GLE-AC\_BO815

AR Frame-BannerWall-bolt  
8x15mm (BW)



**AC BO815**  
Bolt 8x15 mm

€12.00/pc

## GLE-AC\_BR021/B

AR AcrilLight-angle bracket  
acrilight black PVC (PE, AL,  
EL/SQ)



€12.00/pc

## GLE-AC\_BR060/B

AR AcrilLight-round bracket  
acrilight black PVC



€12.00/pc

# Accessories for Aluminium Profile Systems

## GLE-AC\_CD008

AR Frame-BannerWall-banner cord PVC (8 mm) white



€12.00/pc

## GLE-AC\_CLIP

«INFO system» -Clip, black, 0,0015 kg



€12.00/pc

## GLE-AC\_CP026/EL

AR Frame-ClickFrame-decorative corner connector click 26 mm EL gray



€12.00/pc

## GLE-AC\_CP031/B

AR AcrilLight-EL cover acrilight black PVC



€12.00/pc

## GLE-AC\_CP033/SL

AR Frame-ClickFrame-decorative corner connector click 33 mm SL gray



€12.00/pc

## GLE-AC\_CP033/SQ

AR Frame-ClickFrame-decorative corner connector click 33 mm SQ gray



€12.00/pc

## GLE-AC\_CPD062/2B

«INFO system» - Double sided endcap 62 mm, black, 0,009 kg



€12.00/pc

## GLE-AC\_CPD093/2B

«INFO system» - Double sided endcap 93 mm, black, 0,013 kg



€12.00/pc

## GLE-AC\_CPD125/2B

«INFO system» -Double sided endcap 125 mm, black, 0,017 kg



€12.00/pc

## GLE-AC\_CPS031/B

«INFO system» - Single sided endcap 31 mm, black, 0,003 kg



€12.00/pc

## GLE-AC\_CPS062/B

«INFO system» - Single sided endcap 62 mm, black, 0,007 kg



€12.00/pc

## GLE-AC\_CPS093/B

«INFO system» - Single sided endcap 93 mm, black, 0,01 kg



€12.00/pc

## GLE-AC\_CPS125/B

«INFO system» - Single sided endcap 125 mm, black, 0,014 kg



€12.00/pc

## GLE-AC\_RCAP/B

«INFO system» - Endcup for side round profile, black, 0,007 kg



€12.00/pc

## GLE-AC\_RCAP/G

«INFO system» - Endcup for side round profile, grey, 0,007 kg



€12.00/pc

## GLE-AC\_FIX

«INFO system» -Clamp for double sided endcap, black, 0,0018 kg



€12.00/pc

# Accessories for Aluminium Profile Systems

## GLE-AC\_FC006

AR Frame-ClicFrame-corner connector click 25 mm (6 mm) internal screw steel



Click Angle 25 mm (6 mm)  
Inner Screw Steel

€12.00/pc

## GLE-AC\_FC012

AR Frame-TeXFrame-corner connector inpost 12mm without screws steel



Angle Inpost 12 mm Steel  
without Screws, 0.018 kg

€12.00/pc

## GLE-AC\_FC012/SC

AR Frame-TeXFrame-corner connector inpost 12mm with screws steel



Angle Inpost 12 mm Steel  
with Screws, 0.019 kg

€12.00/pc

## GLE-AC\_FC013

AR Frame-ClicFrame-corner connector click 33 mm (13 mm) internal screw steel (TF)

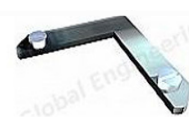

angle bar textile (13 mm) internal  
steel screw

€12.00/pc

## GLE-AC\_CR100/G

AR Frame-BannerWall-corner cover ABS gray small



€12.00/pc

## GLE-AC\_CR200/G

AR Frame-BannerWall-corner cover ABS gray large



€12.00/pc

## GLE-AC\_FS023

AR Frame-ClicFrame-spring click 25 mm (22x23 mm) steel



€12.00/pc

## GLE-AC\_FS027

AR Frame-ClicFrame-spring click 33 mm (22x27 mm) steel



€12.00/pc

## GLE-AC\_LP012/B

AR AcrilLight-hinge acrilight black PVC (PE, AL EL/SQ)



€12.00/pc

## GLE-AC\_LP038

AR Frame-ClicFrame-suspension click steel (BF?5, TF22, PL20/30)



€12.00/pc

## GLE-AC\_LP043

AR Poster-suspension for foam sheets



€12.00/pc

## GLE-AC\_NU006

AR Box-nut ?6 (IB, OB)



€12.00/pc

## GLE-AC\_NU008

AR Frame-BannerWall-nut cap ?8 (BW)



€12.00/pc

## GLE-AC\_PL100

AR Frame-TeXFrame-textile plate 100x12mm internal (BF ?5, CF33)



€12.00/pc

## GLE-AC\_RO111

AR WindowBox Textile roller



€12.00/pc

## GLE-AC\_RU009

AR WindowBox Rubbertape for door 9mm, black



€12.00/pc

# Accessories for Aluminium Profile Systems

## GLE-AC\_RU016

AR WindowBox PVC tape for glass 16 mm, grey



€12.00/pc

## GLE-AC\_SC605

AR WindowBox Screw (6x5 mm)



€12.00/pc

## GLE-AC\_SC608

AR WindowBox Screw (6x8 mm)



€12.00/pc

## GLE-AC\_SU040

AR Box-suction cup



€12.00/pc

## GLE-AC\_TP013A

AR Box-magnetic tape, ? type, CN glue



€12.00/pc

## GLE-AC\_TP013B

AR Box-magnetic tape, B type, CN glue



€12.00/pc

## GLE-AC\_WA008

AR Frame-Toothed Washer M8, AC WA008



€12.00/pc

## GLE-IP\_HINGE

Rainclip I PVC Universal Hinge White

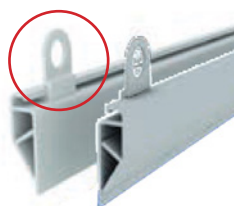

€12.00/pc

## GLE-IP\_RC020/W

Rainclip PVC poster profile WHITE up to 1mm (20x7x0,8 mm) [Length: 3m]

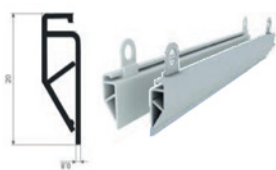

€12.00/pc

## GLE-IP\_RD018/W

Rainclip I PVC banner profile WHITE 1-5 mm (18x11x1 mm) [Length: 3m]

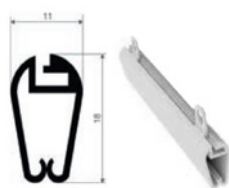

€12.00/pc

## GLE-IP\_RD003/W

Raindrop PVC drop profile WHITE up to 3 mm (14x7x0,8 mm) [Length: 3m]



€12.00/pc

## GLE-IP\_RD005/W

Raindrop PVC drop profile WHITE up to 5 mm (14x7x0,8 mm) [Length: 3m]



€12.00/pc

## GLE-IP\_RD010/W/P

Raindrop PVC U-shaped profile WHITE 10 mm (10x8x1 mm) [Length: 3m]



€12.00/pc



# INFO **NEW** System

The aluminium modular system is a set of components that allows you to create information panels with wide range of sizes and configurations

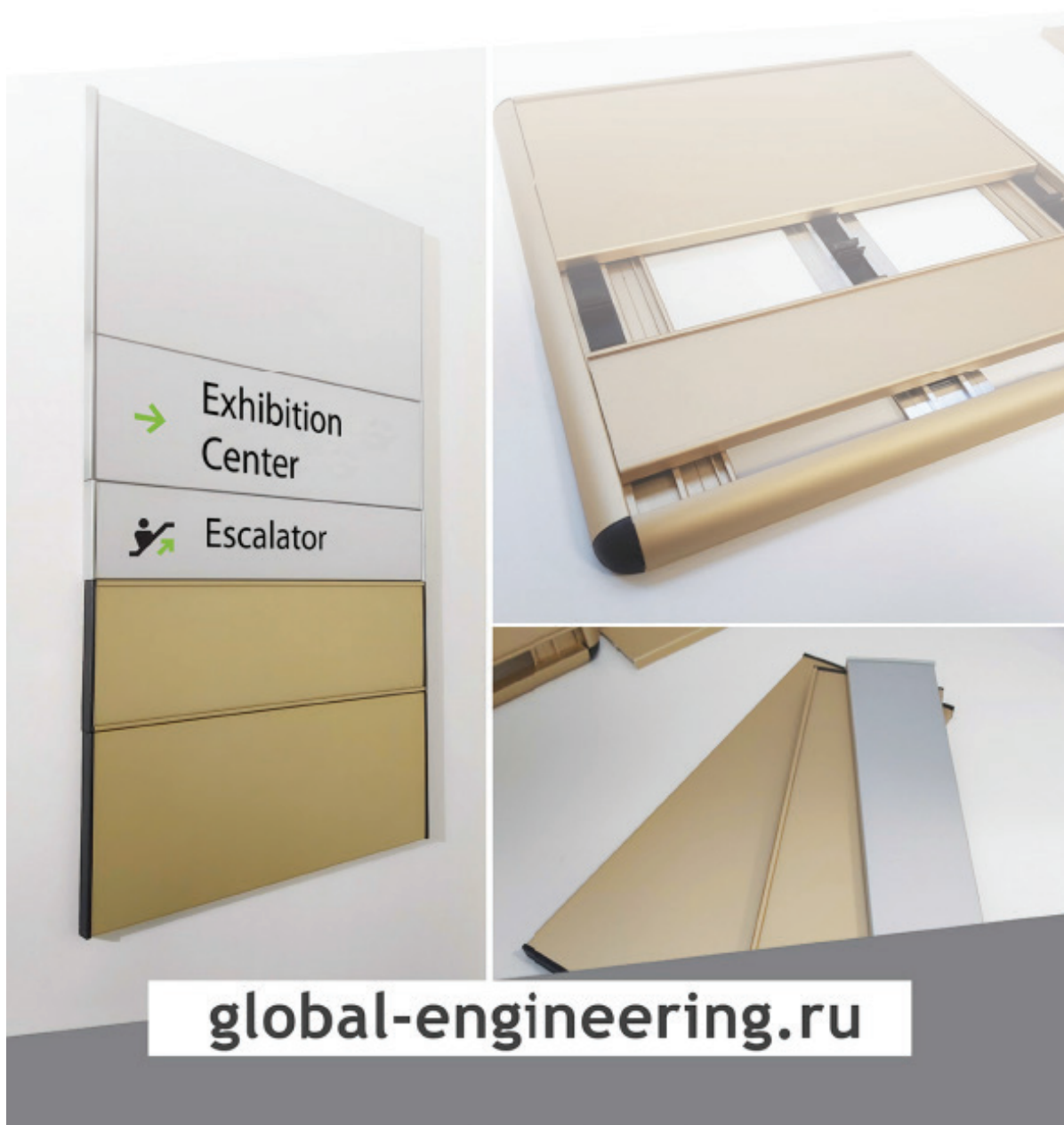

# NEW

# INFO System

Aluminium modular INFO System is a set of components that allows you to create information panels with wide range of sizes and configurations.

## DISPLAY profiles

DISPLAY profiles are created for the production of typesetting panels. Information can be applied by vinyl film or engraving. Profile widths: 31, 62, 93, 125, 156, 187 mm.

**DISPLAY profile 31 mm**  
IS DI31/1SM silver anod matt, 0,19 kg

**DISPLAY profile 62 mm**  
IS DI62/1SM silver anod matt, 0,36 kg

**DISPLAY profile 93 mm**  
IS DI93/1SM silver anod matt, 0,53 kg

**DISPLAY profile 125 mm**  
IS DI125/1SM silver anod matt, 0,73 kg

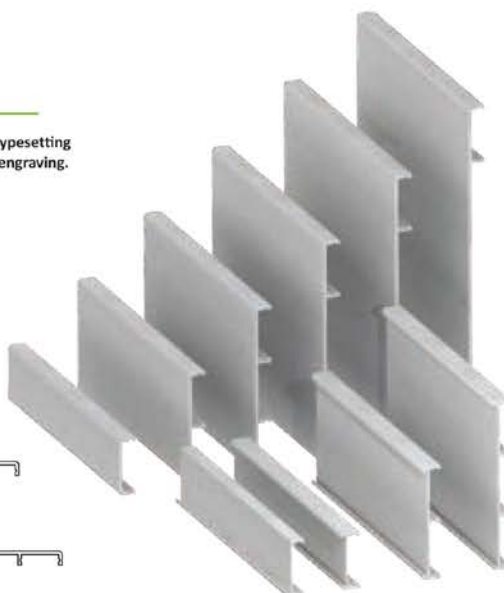

## INSERT profiles

INSERT profiles are used for frequent and rapid change of information on the panels. Information carriers of 0,8-1,2 mm thickness are inserted into the slots. Profile widths: 31, 62, 93 mm.

(1,2 mm)  
**INSERT free profile 31 mm**  
IS FS31/1SM silver anod matt, 0,16 kg  
IS FS31/1GM gold anod matt, 0,16 kg

27 mm  
(0,8 mm)  
**INSERT profile 31 mm**  
IS IN31/1SM silver anod matt, 0,16 kg  
IS IN 31/1GM gold anod matt, 0,16 kg

58 mm  
(1,2 mm)  
**INSERT profile 62 mm**  
IS IN62/1SM silver anod matt, 0,32 kg  
IS IN62/1GM gold anod matt, 0,32 kg

89 mm  
(1,2 mm)  
**INSERT profile 93 mm**  
IS IN 93/1SM silver anod matt, 0,52 kg  
IS IN 93/1GM gold anod matt, 0,52 kg

## TOP/BOTTOM profile

TOP/BOTTOM profile is used to form the frame of the information panel at the top and bottom.



**TOP/BOTTOM profile**  
IS TB15/1SM silver anod matt, 0,21 kg

## MIDDLE profile

MIDDLE profile divides blocks of information in the typesetting panel.

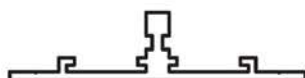

**MIDDLE profile**  
IS MI90/1SM silver anod matt, 0,6kg

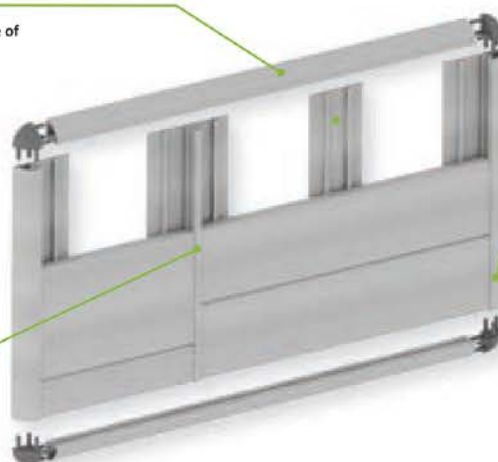

## SIDE profile

SIDE profile is used for mounting DISPLAY and INSERT profiles.



**SIDE round profile**  
IS SI57/1SM silver anod matt, 0,43 kg

## Double sided endcaps

2x

■ Black

Double sided endcaps are used to make hanging information plates. Compatible with DISPLAY and INSERT profiles.



AC FIX/ black  
Clamp  
Special clamp  
is fixing profile  
in the endcap

AC CP062/2



62

AC CP093/2



9

AC CP093/2



AC CP093/2



AC CP093/2



## Endcup for side round profile



AC RCAP

Endcup for side round profile is used to make complex information panels. Compatible with SIDE round and TOP/BOTTOM profiles. Available in gray and black color.

■ Gray  
■ Black



AC CLIP/ black

Clip

Clip is fixing DISPLAY and INSERT profiles in the SIDE profile.

# INFO System

# Components

## Single sided endcaps

1x

■ Black

Single sided endcaps are used to make wall mounted information plates. Compatible with DISPLAY and INSERT profiles.

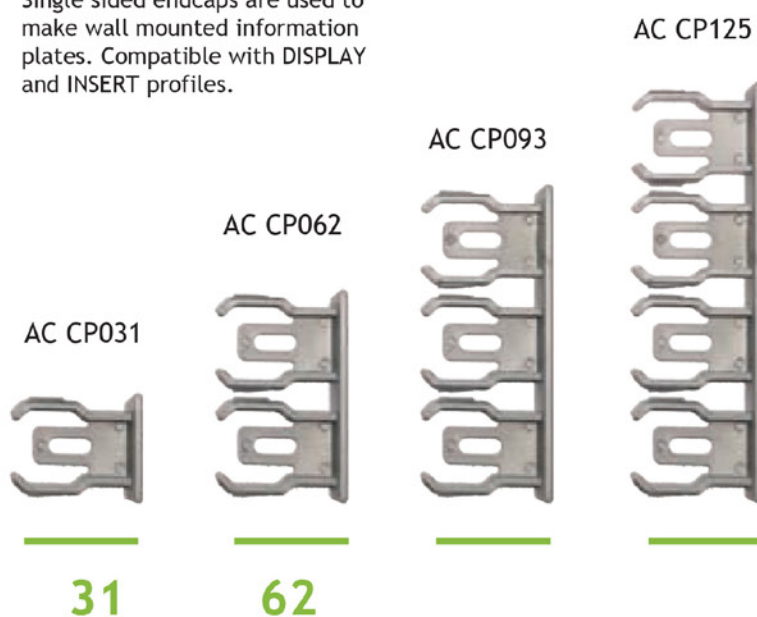



# Suspension for Foam Board

Hinge is designed to suspend Foam Board  
on vertical surfaces.

It is securely secured in the Sheet using Spikes which  
are pressed into the Foam Board Soft Structure.

Made of Steel with Zinc Coating.



## System Components

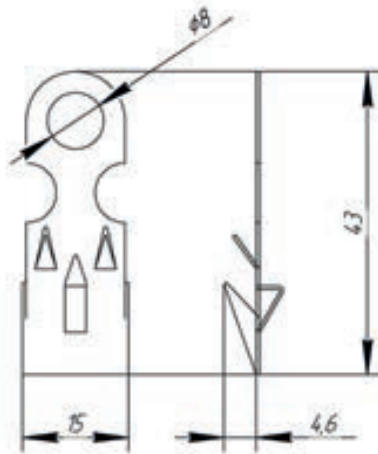

### AC LPO43

Hinge Foam Board  
Steel 0.002 kg



# AR Profile | Connecting profiles

Item	Cross-section	Photo	Description
<b>PR SF003</b> Profile 3 mm F-Shape, unpainted 6.1 m, 1.2 kg			Profile is used for mounting of Composite Panels and 3 mm thick Sheet Materials.
<b>PR SC003</b> Profile 3 mm Angular, anode, matt silver, 6.1 m, 1.64 kg			Profile is used for mounting and docking at 90° of Composite Panels and 3 mm thick Sheet Materials, as well as designing of Volumetric Shapes.
<b>PR SH003</b> Profile 3 mm H-Shape anode, matt silver, 6.1 m, 1.36 kg			Profile is used for mounting and docking at 180° of Composite Panels and 3 mm thick Sheet Materials.
<b>PR SU003</b> Profile 3 mm U-Shape anode, matt silver, 6.1 m, 0.72 kg			Profile is used for framing of Composite Panels and 3 mm thick Sheet Materials.

# Aluminium Sign Systems



## Andreas Jacovides Trading Ltd

+357 22 866300 | Fax: +357 22 454843

@ sales@ajacovides.com

9 Invrou, Industrial Area of Latsia | 2234 Nicosia, Cyprus | P.O.Box 17047, 2260 Latsia | Nicosia, Cyprus

A. Jacovides Trading Ltd @ ajacovidestrading in Andreas Jacovides Trading Ltd



2022